

CORNICES, VALANCES, AND PALLADIAN WINDOW SHELF

Table of Contents

Features

Wood Characteristics	2
Wood Cornices	3
Wood Valances	3
Composite and Faux Wood Valances	3
Palladian Window Shelf	3

Size Considerations

Cornice and Valance	4
Palladian Window Shelf	4

Options

Wood Cornices	5
Wood Valances	6
Composite and Faux Wood Valances	7
Decorative Keystones	8
Splicing Requirements	8
Palladian Window Shelf	9

General Information

Valance Returns: Horizontal Blinds	10-11
Wood Valance Returns	12-13
Wood Cornice Returns	14-15
Composite and Faux Wood Valance Returns	16
How to Measure for Valance Returns	17
How to Measure and Order Cornices and Valances	18
How to Measure a Special Splice Location	19
Custom Color	19
Mounting Brackets	20

Price Charts and Options Pricing

Wood Cornice Pricing	21
Decorative Cornice Keystone Pricing	21
Custom Color Pricing	21
Wood Valance Pricing	22
Decorative Wood Valance Keystone Pricing	22
Custom Color Pricing	22
Composite and Faux Wood Valance Pricing	22
Palladian Window Shelf Pricing	22



Features

Cornices and valances easily lend an impressive touch to windows and doors. Used on their own or over window treatments, cornices and valances are as decorative as they are functional.

Palladian window shelves create a mounting surface for unique or difficult installations.

- Unique styles of wood cornices, wood valances, and faux wood valances provide the perfect solution for any décor
- Wood cornices and valances are crafted from premium North American hardwood and are available in all paints and stains to coordinate with Graber® Wood Blinds, as well as unfinished
- Dress up a drab window
- Enlarge a window
- Keystones are included with a spliced cornice or wood valance
- Additional keystones are available as a surcharge option for cornices or wood valances that do not require splices

Wood Characteristics



Flat Grain



Grain Change



Tiger Striping



Burl/Bird's Eye



Pin Knots



Mineral Marks



Knotty Pine/
Rustic



Knotty Pine/
Rustic

Wood used to manufacture Graber Wood Blinds has many natural characteristics which make it truly unique...no two pieces of hardwood are alike. The following are all natural characteristics of wood and we do not consider them to be defects:

- Grain—The direction, size, and appearance of wood fibers vary greatly depending on where the wood is cut from within the tree
- Tiger Striping—Occurs when a tree develops wavy grain, due to genetics, soil content, or other natural scenarios
- Burl Grain—Formed from an irregular growth on the outer edge of the tree
- Bird's Eye—Small area on the surface of the board where fibers are contorted to form circular figures that resemble birds' eyes
- Pin Knots—Vary in size, shape, structure, and color
- Mineral Marks—Dark or discolored area caused by minerals which the tree extracts from the water or soil; can be either a streak or a stain, usually blackish blue
- Knotty Pine/Rustic—Material contains markings that are more extreme than in standard products; the number and degree of marking will vary throughout the blind

Please be assured that these markings in no way affect the durability or the structural integrity of the blind.

Natural variations in color and grain effect are inherent in the beauty of wood. These variations are within established industry guidelines and should be expected. When two or more pieces of wood are spliced together to create wider valances or cornices, there may be variations in the dye lot and grain between the sections. In addition, valances and cornices may stain slightly darker or lighter than the samples shown in the sample books and selectors.

Features

Wood Cornices

- Crafted from premium North American hardwood
- Fine furniture-quality finish
- L-brackets are included for easy installation
- Cornices are available in all paints and stains to coordinate with Graber® Traditions® Wood Blinds, as well as unfinished or custom color
- Keystones are included with spliced cornices and are available as a surcharge option for cornices that do not require a splice

Wood Valances

- Crafted from premium North American hardwood
- Fine furniture-quality finish
- Includes mounting hardware for specified product use
- Valances are available in all paints and stains to coordinate with Graber Wood Blinds, as well as unfinished or custom color
- Keystones are included with spliced valances and are available as a surcharge option for valances that do not require a splice

Composite and Faux Wood Valances

- Composite and faux wood options are ideal for a finishing look in a high humidity room
- Includes mounting hardware for specified product use

Palladian Window Shelf

- Crafted from premium North American hardwood
- Fine furniture-quality finish
- Available in all paints and stains to coordinate with Graber Wood Blinds, as well as unfinished or custom color
- Create a mounting surface for unique or difficult installations
- Available in depths from 4" (10.2 cm) to as narrow as 2" (5.1 cm)
- Mounting hardware included

Size Considerations

Cornice and Valance

Type of Valance or Cornice	Minimum Width		Maximum Width without Splicing		Maximum Width with Splicing	
	Inside Mount inches (cm)	Outside Mount inches (cm)	Inside Mount No Returns inches (cm)	Outside Mount or Inside Mount with Returns inches (cm)	Inside Mount inches (cm)	Outside Mount inches (cm)
2½" (6.4 cm) Classic Barnwood Valance†	8¼ (21.0)	8 (20.4)	100¼ (254.7)	98% (249.9)	300¼ (764.0)	298¾ (759.2)
3" (7.7 cm) Classic Wood Valance	8¼ (21.0)	8 (20.4)	100¼ (254.7)	98% (249.9)	300¼ (764.0)	298¾ (759.2)
3½" (8.9 cm) Craftsman Wood Valance	8¼ (21.0)	8 (20.4)	100¼ (254.7)	98% (249.9)	300¼ (764.0)	298¾ (759.2)
3½" (8.9 cm) Legacy Wood Valance	8¼ (21.0)	8 (20.4)	100¼ (254.7)	98% (249.9)	300¼ (764.0)	298¾ (759.2)
4½" (11.5 cm) Symphony Wood Valance/Cornice^	8¼ (21.0)	8 (20.4)	100¼ (254.7)	98% (249.9)	300¼ (764.0)	298¾ (759.2)
3" (7.7 cm) Classic Composite or Faux Wood Valance†	8¼ (21.0)	8 (20.4)	106% (270.9)	105% (267.7)	300 (762.0)	298¾ (758.9)
3" (7.7 cm) Majestic Composite or Faux Wood Valance†	8¼ (21.0)	8 (20.4)	106% (270.9)	105% (267.7)	300 (762.0)	298¾ (758.9)
5½" (14.0 cm) Noble Wood Cornice^	8¼ (21.0)	8 (20.4)	94 (238.8)	92% (234.0)	366 (929.7)	366 (929.7)
7½" (19.1 cm) Noble Wood Cornice^	8¼ (21.0)	8 (20.4)	94 (238.8)	91% (232.1)	366 (929.7)	366 (929.7)
5½" (14.0 cm) Regal Wood Cornice^	8¼ (21.0)	8 (20.4)	94 (238.8)	91% (231.5)	366 (929.7)	366 (929.7)
7½" (19.1 cm) Regal Wood Cornice^	8¼ (21.0)	8 (20.4)	94 (238.8)	90 (228.6)	366 (929.7)	366 (929.7)

^Inside mount wood cornices that require a keystone cannot be mounted flush to the top of the window casing. There will be approximately a ¼" (0.7 cm) gap at the top and the installation brackets may be visible with this application.

†Keystones not available on authentic hardwood, barnwood, distressed wood, in sandblast finish, composite, or faux wood valances.

NOTE: Cornices and valances wider than the widths shown in the chart above will be manufactured in multiple sections. The sections must be assembled during installation. Customer may request specific locations for the splices as long as it does not exceed our maximum single piece size. All requests for additional cornice or wood valance splices require a keystone. The keystone surcharge applies to each additional splice.

These formulas are used to calculate BACKSIDE valance measurements by product type.

All Except: • Natural Drapes • Sheer Verticals • Artisan Fabric Roman Shades • Other Applications	Inside mount	No returns	OW -¼" (0.2 cm)
Natural Drapes	Inside mount	With returns	OW +½" (1.3 cm)
	Outside mount	No returns	OW +½" (1.3 cm)
Natural Drapes	Inside mount	With returns	OW +¾" (2.0 cm)
		Outside mount	No returns
	Outside mount	With returns	OW +¾" (2.0 cm)
Sheer Verticals	Inside mount	No returns	OW -¼" (0.2 cm)
		With returns	OW +¾" (2.0 cm)
	Outside mount	No returns	OW +½" (1.3 cm)
Artisan Fabric Roman Shades	Inside mount	With returns	OW +¾" (2.0 cm)
		Outside mount	No returns
	Outside mount	With returns	OW +½" (1.3 cm)
Other Applications	Inside mount	No returns	OW -¼" (0.2 cm)
		With returns	OW +¾" (2.0 cm)
	Outside mount	No returns	OW +¼" (0.7 cm)
		With returns	OW +4" (10.2 cm)
Other Applications	Inside mount	No returns	OW -¼" (0.2 cm)
		With returns	OW +¾" (2.0 cm)
	Outside mount	No returns	OW +¼" (0.7 cm)
		With returns	OW +4" (10.2 cm)

These formulas are used to calculate BACKSIDE cornice measurements by product type.

All Except: • Natural Drapes • Sheer Verticals • Artisan Fabric Roman Shades • Other Applications	Inside mount	No returns	OW -¼" (0.2 cm)
Natural Drapes	Inside mount	With returns	OW +¾" (2.0 cm)
	Outside mount	No returns	OW -¼" (0.2 cm)
Natural Drapes	Inside mount	With returns	OW +¾" (2.0 cm)
		Outside mount	No returns
	Outside mount	With returns	OW +1" (2.6 cm)
Sheer Verticals	Inside mount	No returns	OW -¼" (0.2 cm)
		With returns	OW +¾" (2.0 cm)
	Outside mount	No returns	OW +½" (1.3 cm)
Artisan Fabric Roman Shades	Inside mount	No returns	OW -¼" (0.2 cm)
		With returns	OW +¾" (2.0 cm)
	Outside mount	No returns	OW +2" (5.1 cm)
Other Applications	Inside mount	No returns	OW -¼" (0.2 cm)
		With returns	OW +¾" (2.0 cm)
	Outside mount	No returns	OW +¼" (0.7 cm)
		With returns	OW +4" (10.2 cm)

If the product option of other is selected during entry, the backside cornice/valance measurement will be the exact width entered. There will be no additions or deductions taken. Cornice or valance return size must be specified. Soft drapery falls within the 'other applications' category.

Palladian Window Shelf

	Minimum Width Inside Mount Only inches (cm)	Maximum Width Inside Mount Only inches (cm)	Minimum Depth inches (cm)	Maximum Depth inches (cm)
Palladian Window Shelf	7 (17.8)	96 (243.9)	2 (5.1)	4 (10.2)

NOTE: Inside mount application only. The finished shelf will be ordered width less ¼" (0.2 cm). The shelf is designed for end mounting, no center supports are available. End mounting brackets must be mounted to a flat vertical surface. If installation is inside an arch, the top of the palladian shelf must be mounted at or below the start of the arch curve. Shelf can be installed in a vertical application to divide a large window. Depending on the width of the window opening and the weight of the blind or shade, deflection up to ½" (1.3 cm) may occur.

Options

Wood Cornices

- Crafted from premium North American hardwood
- Fine furniture-quality finish
- Installation hardware is included for easy installation
- Cornices available in all paints and stains to coordinate with Graber® Wood Blinds, as well as unfinished or with custom color
- Inside mount has straight cut ends, no returns, no dust cover
- Outside mount has mitered corners, returns, and a dust cover* to conceal the top of the blind
- Custom returns may be ordered for outside mount up to 8" (20.4 cm), minimum return is ½" (1.3 cm)
- Cornices not available on bay or corner windows
- Single side return available; opposite end will be straight cut

*Dust cover is unfinished and will not match selected color.

NOTE: Wood cornice will be shipped separate from blinds. Manufacturer recommends installing blind and cornice at the same time.

Regal Wood—Outside Mount

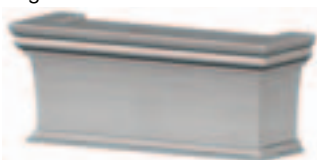

Regal Wood—Inside Mount

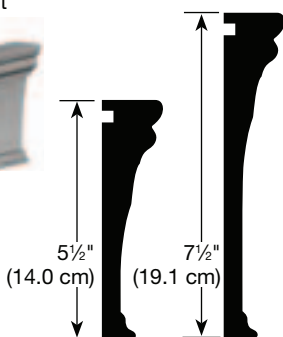
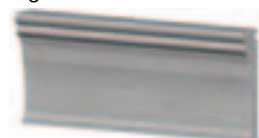

Regal Wood Cornice

Available in either a 5½" (14.0 cm) or 7½" (19.1 cm) size and in all colors listed below.

Noble Wood Cornice

Available in either a 5½" (14.0 cm) or 7½" (19.1 cm) size and in all colors listed below.

Noble Wood—Outside Mount



Noble Wood—Inside Mount

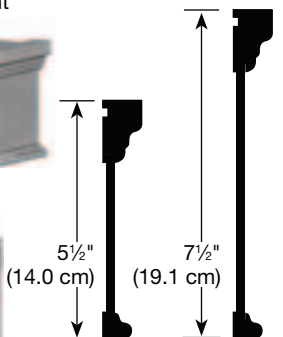

Paint Colors

Angora	1052
Antique White	1026
Base White	1051
Crisp White	1712
Custom Color*	CUSP
Dover White	1683
Dovetail	1839
Grey Beige	1817
Medium Grey	1841
Pearl	1840
Snow White	1850
Snowflake	1603
Stepping Stone	1889
Stucco	1963

Stain Colors

Allspice	1821	Honey Maple	1013
Cappuccino	1546	Natural	1007
Cherry Wood	1014	Roasted Chestnut	1849
Cognac	1465	Saddle Brown	1694
Custom Color*	CUSS	Sienna	1685
Dark Cherry	1316	Timeless Grey	1847
Dark Walnut	1641	True Taupe	1848
Espresso	1716	Truffle	1054
Golden Oak	1030	Unfinished	1717
Harbor Grey	1761	Walnut	1012
Henna	1949	Wheat	1710
Homestead Oak	1943		

Symphony Wood—Outside Mount



Symphony Wood—Inside Mount



Symphony Wood Cornice

Available in 4½" (11.5 cm) size and in all colors listed below.

Paint Colors

Angora	1052
Antique White	1026
Base White	1051
Crisp White	1712
Custom Color*	CUSP
Dover White	1683
Dovetail	1839
Grey Beige	1817
Medium Grey	1841
Medium Grey Sandblast†	SB841
Pearl	1840
Snow White	1850
Snowflake	1603
Snowflake Sandblast†	SB603
Stepping Stone	1889
Stucco	1963

Stain Colors

Allspice	1821	Honey Maple	1013
Cappuccino	1546	Knotty Pine	1515
Cherry Wood	1014	Natural	1007
Cognac	1465	Roasted Chestnut	1849
Custom Color*	CUSS	Saddle Brown	1694
Dark Cherry	1316	Sienna	1685
Dark Walnut	1641	Timeless Grey	1847
Espresso	1716	True Taupe	1848
Golden Oak	1030	Truffle	1054
Harbor Grey	1761	Unfinished	1717
Henna	1949	Walnut	1012
Homestead Oak	1943	Wheat	1710

*Custom color: see pricing section for net surcharge per color.

†Keystones are not available in sandblast finish, but will come in matching paint color in a smooth finish.

Options

Wood Valances

- Painted and stained valances crafted from premium North American hardwood
- Fine furniture-quality finish
- Returns for inside mount must be specified
- Inside mount has straight cut ends, no returns
- Outside mount has mitered corners and returns
- Custom returns may be ordered for both inside and outside mount up to 8" (20.4 cm), minimum return is ½" (1.3 cm)
- Valances only available on bay and corner windows if bay and corner application is available on entire product line selected
- Single side return available; opposite end will be straight cut

NOTE: Wood valance will be shipped separate from blinds. Manufacturer recommends installing blind and valance at the same time.

Classic—Outside Mount



Classic—Inside Mount

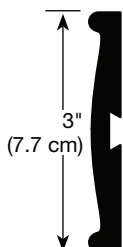

Classic Valance

3" (7.7 cm) available in all colors at bottom of page.

2½" (6.4 cm) available in barnwood, not available with keystones.

Barnwood Colors

Medium Pewter . . . 1049

Windswept. 1072

Legacy—Outside Mount



Legacy—Inside Mount

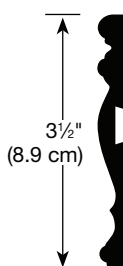
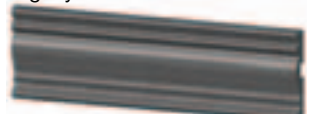

3½" (8.9 cm) Legacy Valance

Available in all colors at bottom of page.

Available in distressed wood and authentic hardwood, not available with keystones.

Distressed Wood Colors

Smoky Coal 1572

Twig 1070

Authentic Hardwood Colors

Cherry C007

Maple M007

Walnut W007

Craftsman—Outside Mount



Craftsman—Inside Mount

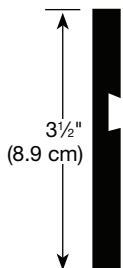

3½" (8.9 cm) Craftsman Valance

Available in all colors at bottom of page.

Symphony—Outside Mount



Symphony—Inside Mount

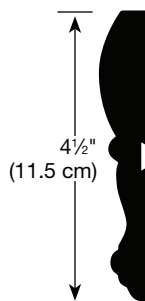

4½" (11.5 cm) Symphony Wood Valance

Available in all colors at bottom of page.

Paint Colors

Angora 1052	Medium Grey 1841
Antique White 1026	Medium Grey Sandblast† .SB841
Base White 1051	Pearl 1840
Crisp White 1712	Snow White 1850
Custom Color* CUSP	Snowflake 1603
Dover White 1683	Snowflake Sandblast† . SB603
Dovetail 1839	Stepping Stone 1889
Grey Beige 1817	Stucco 1963

Stain Colors

Allspice 1821	Natural 1007
Cappuccino 1546	Roasted Chestnut 1849
Cherry Wood 1014	Rustic Cognac R1465
Cognac 1465	Rustic Golden Oak . . . R1030
Custom Color* CUSS	Rustic Harbor Grey . . . R1761
Dark Cherry 1316	Saddle Brown 1694
Dark Walnut 1641	Sienna 1685
Espresso 1716	Timeless Grey 1847
Golden Oak 1030	True Taupe 1848
Harbor Grey 1761	Truffle 1054
Henna 1949	Unfinished 1717
Homestead Oak 1943	Walnut 1012
Honey Maple 1013	Wheat 1710
Knotty Pine 1515	

*Custom color: see pricing section for net surcharge per color.

†Keystones are not available in sandblast finish, but will come in matching paint color in a smooth finish.

Options

Composite and Faux Wood Valances

- Composite and faux wood valance options are ideal for a finished look in a high humidity room
- Includes mounting hardware for specified product use
- Returns for inside mount must be specified
- Inside mount has straight cut ends, no returns
- Outside mount has mitered corners and returns
- Custom returns may be ordered for both inside and outside mount up to 8" (20.4 cm), minimum return is ½" (1.3 cm)
- Valances only available on bay and corner windows if bay and corner application is available on entire product line selected
- Single side return available; opposite end will be straight cut
- Not available with keystones

NOTE: Composite and faux wood valances will be shipped separate from blinds. Manufacturer recommends installing blind and valance at the same time.

Classic—Outside Mount



Classic—Inside Mount



3" (7.7 cm) Classic Composite and Faux Wood Valance

Add a classic touch to any room.

Available in all colors listed at the bottom of page.

Majestic—Outside Mount

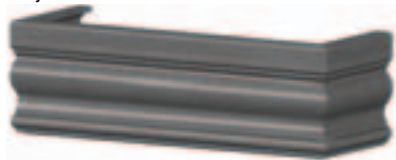

Majestic—Inside Mount

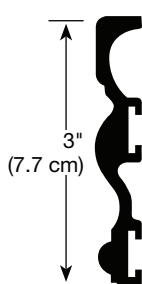
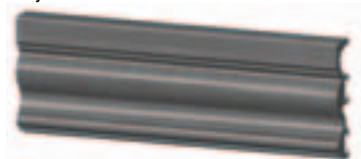

3" (7.7 cm) Majestic Composite and Faux Wood Valance

Add a decorative element to the window.

Available in all colors listed at the bottom of page.

Composite Colors

Antique White	2026
Base White	2051
Creamy White	2729
Seattle Grey	2174
Silk White	2922

Premium Faux Wood Colors

Cognac	2465
Dark Cherry	2316
Golden Oak	2030
Honey Maple	2013
Misty Grey	2230
Moonshine	2738
Morel	2706
Natural	2007
Phantom	2707
Saddle Brown	2694
Sienna	2685
Walnut	2012
Wheat	2710

Faux Wood Colors

Almond	5724
Buttermilk	5078
Buttermilk Textured†	5953
Coconut	5630
Coconut Textured†	5299
Marshmallow	5742
Milky Way	5058
Milky Way Textured†	5304
Seattle Grey	5174
White	5035
White Textured†	5951

†Classic valance will be textured. Majestic valance will be color coordinated in a smooth finish.

Options

Decorative Keystones



- Decorative keystones are required on wood cornices and valances that require splicing
- The keystones will be equally spaced unless special splice locations are requested at time of order
- Keystones can be requested on wood cornices without a splice at time of order
 - Minimum width with a keystone: 12" (30.5 cm)
 - Maximum number of keystones: 3
- Keystones will be stained or painted to match the valance or cornice ordered as standard; optional different color selection available
- Keystones not available on authentic hardwood, barnwood, distressed wood, in sandblast finish, composite, or faux wood valances
- All inside mount applications will have a slight light gap at the top of the cornice or valance when installed with a keystone
- Keystones cannot be added to existing valances or symphony cornices because the keystones require splicing at the time of order

Splicing Requirements

Profile	Number of Sections	Number of Keystones	No Returns		With Returns (inside dimensions)	
			Minimum inches (cm)	Maximum inches (cm)	Minimum inches (cm)	Maximum inches (cm)
2½" (6.4 cm) Classic Barnwood Valance*	1	0	8 (20.4)	100¼ (254.7)	8 (20.4)	98¾ (249.9)
3" (7.7 cm) Classic Wood Valance	2	1	100⅞ (254.8)	200½ (509.3)	98⅞ (250.1)	198⅞ (504.6)
3½" (8.9 cm) Craftsman Wood Valance						
3½" (8.9 cm) Legacy Wood Valance	3	2	200⅞ (509.5)	300¼ (764.0)	198⅞ (504.7)	298⅞ (759.2)
4½" (11.5 cm) Symphony Wood Valance/Cornice						
5½" (14.0 cm) Noble Cornice	1	0	8 (20.4)	94 (238.8)	8 (20.4)	92½ (234.0)
	2	1	94⅞ (239.0)	187⅞ (475.2)	92⅞ (234.2)	185⅞ (470.4)
	3	2	187⅞ (475.3)	280⅞ (711.6)	185¼ (470.6)	278¼ (706.8)
	4	3	280⅞ (711.7)	366 (929.7)	278⅞ (707.0)	366 (929.7)
7½" (19.1 cm) Noble Cornice	1	0	8 (20.4)	94 (238.8)	8 (20.4)	91¾ (232.1)
	2	1	94⅞ (239.0)	186⅞ (474.2)	91⅞ (232.3)	184⅞ (467.6)
	3	2	186¾ (474.4)	279⅞ (709.7)	184⅞ (467.7)	276¾ (703.0)
	4	3	279⅞ (709.8)	366 (929.7)	276⅞ (703.2)	366 (929.7)
5½" (14.0 cm) Regal Cornice	1	0	8 (20.4)	94 (238.8)	8 (20.4)	91½ (231.5)
	2	1	94⅞ (239.0)	186⅞ (473.9)	91⅞ (231.7)	183⅞ (466.6)
	3	2	186⅞ (474.1)	279⅞ (709.0)	183¾ (466.8)	276¼ (701.7)
	4	3	279⅞ (709.2)	366 (929.7)	276⅞ (701.9)	366 (929.7)
7½" (19.1 cm) Regal Cornice	1	0	8 (20.4)	94 (238.8)	8 (20.4)	90 (228.6)
	2	1	94⅞ (239.0)	186 (472.5)	90⅞ (228.8)	182 (462.3)
	3	2	186⅞ (472.6)	278 (706.2)	182⅞ (462.5)	274 (696.0)
	4	3	278⅞ (706.3)	366 (929.7)	274⅞ (696.2)	366 (929.7)

*Keystones not available.

Outside Mount

- Wood cornices and valances requiring a splice will include a keystone (see chart above for details)

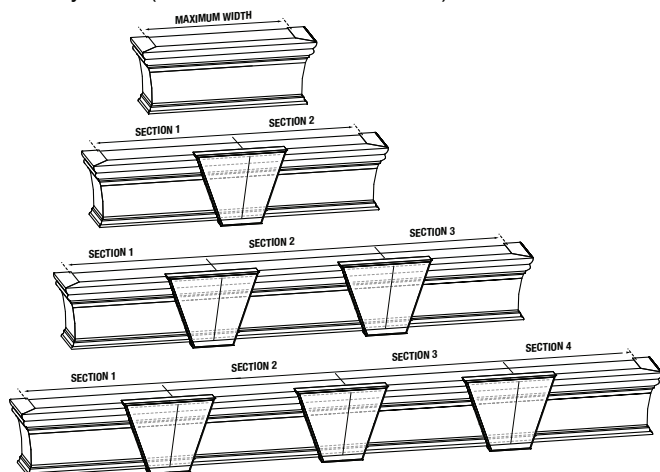

Inside Mount

- Wood valances 100¼" (254.7 cm) or wider and cornices 94" (238.8 cm) or wider will require a keystone

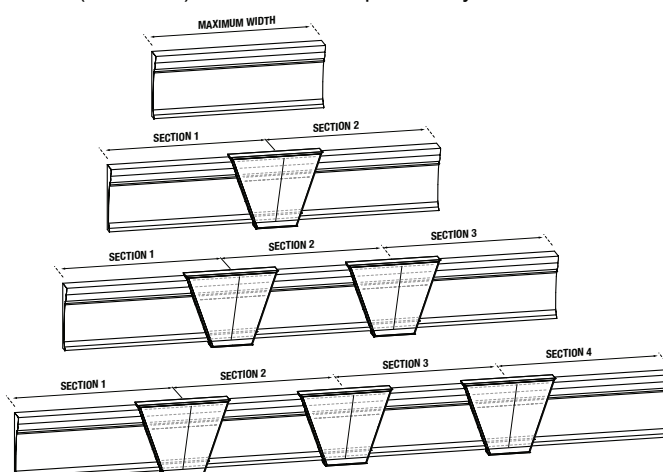

Options

Palladian Window Shelf

A wood shelf or header that may be installed in applications lacking a window frame for mounting a blind. Blinds or other window treatments may be installed either above or below the shelf.

- Created from premium North American hardwood
- Use with any Graber® blind or shade
- Ideal for arch top windows
- Use as a divider for long windows
- Easy mounting brackets included
- Available in all paints and stains to coordinate with Graber Wood Blinds, as well as unfinished or with custom color
- Available in depths from 4" (10.2 cm) to as narrow as 2" (5.1 cm)

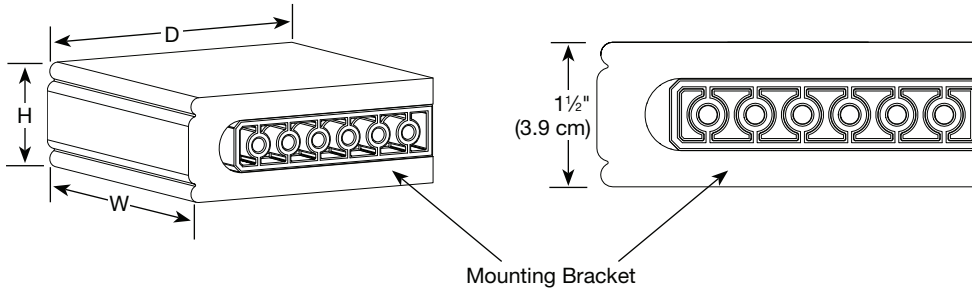



Paint Colors		Stain Colors	
Angora	1052	Grey Beige	1817
Antique White	1026	Medium Grey	1841
Base White	1051	Pearl	1840
Crisp White	1712	Snow White	1850
Custom Color*	CUSP	Snowflake	1603
Dover White	1683	Stepping Stone	1889
Dovetail	1839	Stucco	1963
		Allspice	1821
		Cappuccino	1546
		Cherry Wood	1014
		Cognac	1465
		Custom Color*	CUSS
		Dark Cherry	1316
		Dark Walnut	1641
		Espresso	1716
		Golden Oak	1030
		Harbor Grey	1761
		Henna	1949
		Homestead Oak	1943
		Honey Maple	1013
		Natural	1007
		Roasted Chestnut	1849
		Saddle Brown	1694
		Sienna	1685
		Timeless Grey	1847
		True Taupe	1848
		Truffle	1054
		Unfinished	1717
		Walnut	1012
		Wheat	1710

*Custom color: see pricing section for net surcharge per color.

General Information

Valance Returns: Horizontal Blinds

Returns for inside mount must be specified.

Valance Type	Blind Type	Maximum Continuous Width*		Control Type	Outside Mount Returns inches (cm)	Full Recess Depth inches (cm)
		Inside Mount No Returns inches (cm)	Inside Mount with Returns inches (cm)			
2½" (6.4 cm) Classic Valance  Valance Returns ½" (1.3 cm) to 1" (2.6 cm): glued 1⅛" (2.7 cm) to 4⅝" (11.8 cm): optional glued 4⅞" (12.0 cm) and greater: not glued	2" (5.1 cm) Barnwood [^]	100¼ (254.7)	98⅝ (249.9)	Cord tilt	2⅞ (7.4)	3¼ (8.3)
				Wand tilt	3⅞ (9.1)	3⅞ (9.9)
				Cordless wand tilt	3⅞ (8.6)	3¼ (9.6)
				Cordless cord tilt	2¾ (7.0)	3⅞ (7.8)
3" (7.7 cm) Classic Valance  Valance Returns ½" (1.3 cm) to 1" (2.6 cm): glued 1⅛" (2.7 cm) to 4⅝" (11.8 cm): optional glued 4⅞" (12.0 cm) and greater: not glued	1" (2.6 cm) Wood	100¼ (254.7)	98⅝ (249.9)	Wand tilt	2⅞ (5.3)	2⅞ (6.1)
	2" (5.1 cm) Wood 2" (5.1 cm) Elite Wood 2" (5.1 cm) Aluminum [†] 2" (5.1 cm) Vinyl [†]	100¼ (254.7)	98⅝ (249.9)	Cord tilt	2⅞ (7.4)	3¼ (8.3)
				Wand tilt	3⅞ (9.1)	3⅞ (9.9)
				Cordless wand tilt	3⅞ (8.6)	3¼ (9.6)
				Cordless cord tilt	2¾ (7.0)	3⅞ (7.8)
	2⅝" (6.1 cm) Wood 2⅝" (6.1 cm) Elite Wood	100¼ (254.7)	98⅝ (249.9)	Cord tilt	3¼ (9.6)	4⅞ (10.4)
				Cordless wand tilt	3⅞ (9.1)	3⅞ (10.1)
	Cordless cord tilt	100¼ (254.7)	98⅝ (249.9)	Cordless cord tilt	3⅞ (9.1)	3⅞ (10.1)
				N/A	5½ (14.0)	5⅞ (14.8)
	Wood Verticals	100¼ (254.7)	98⅝ (249.9)	Cord tilt	2⅞ (7.4)	3¼ (8.3)
				Wand tilt	3⅞ (9.1)	3⅞ (9.9)
	2" (5.1 cm) Composite [^]	106⅝ (270.9)	105⅝ (267.7)	Cordless wand tilt	3⅞ (8.6)	3¼ (9.6)
				Cordless cord tilt	2¾ (7.0)	3⅞ (7.8)
	2½" (6.4 cm) Composite [^]	106⅝ (270.9)	105⅝ (267.7)	Cord tilt	3⅞ (10.1)	4¼ (10.8)
Cordless wand tilt				3¼ (9.6)	4⅞ (10.5)	
Cordless cord tilt	106⅝ (270.9)	105⅝ (267.7)	Cordless cord tilt	3¼ (9.6)	4⅞ (10.5)	
			Cord tilt	2⅞ (7.4)	3¼ (8.3)	
2" (5.1 cm) Premium Faux Wood [^] 2" (5.1 cm) Faux Wood [^]	106⅝ (270.9)	105⅝ (267.7)	Wand tilt	3⅞ (9.1)	3⅞ (9.9)	
			Cordless wand tilt	3⅞ (8.6)	3¼ (9.6)	
Cordless cord tilt	106⅝ (270.9)	105⅝ (267.7)	Cordless cord tilt	2¾ (7.0)	3⅞ (7.8)	
			Cord tilt	3⅞ (10.1)	4¼ (10.8)	
2½" (6.4 cm) Premium Faux Wood [^] 2½" (6.4 cm) Faux Wood [^]	106⅝ (270.9)	105⅝ (267.7)	Cordless wand tilt	3¼ (9.6)	4⅞ (10.5)	
			Cordless cord tilt	3¼ (9.6)	4⅞ (10.5)	
3" (7.7 cm) Majestic Valance  Valance Returns ½" (1.3 cm) to 1" (2.6 cm): glued 1⅛" (2.7 cm) to 4⅝" (11.8 cm): optional glued 4⅞" (12.0 cm) and greater: not glued	2" (5.1 cm) Composite [^]	106⅝ (270.9)	105⅝ (267.7)	Cord tilt	2⅞ (7.4)	3⅞ (8.6)
				Wand tilt	3⅞ (9.1)	4⅞ (10.4)
				Cordless wand tilt	3⅞ (8.6)	3⅞ (9.9)
				Cordless cord tilt	2¾ (7.0)	3⅞ (8.1)
	2½" (6.4 cm) Composite [^]	106⅝ (270.9)	105⅝ (267.7)	Cord tilt	3⅞ (10.1)	4⅞ (11.3)
				Cordless wand tilt	3¼ (9.6)	4¼ (10.8)
				Cordless cord tilt	3¼ (9.6)	4¼ (10.8)
				Cord tilt	2⅞ (7.4)	3⅞ (8.6)
2" (5.1 cm) Premium Faux Wood [^] 2" (5.1 cm) Faux Wood [^]	106⅝ (270.9)	105⅝ (267.7)	Wand tilt	3⅞ (9.1)	4⅞ (10.4)	
			Cordless wand tilt	3⅞ (8.6)	3⅞ (9.9)	
			Cordless cord tilt	2¾ (7.0)	3⅞ (8.1)	
			Cord tilt	3⅞ (10.1)	4⅞ (11.3)	
2½" (6.4 cm) Premium Faux Wood [^] 2½" (6.4 cm) Faux Wood [^]	106⅝ (270.9)	105⅝ (267.7)	Cordless wand tilt	3¼ (9.6)	4¼ (10.8)	
			Cordless cord tilt	3¼ (9.6)	4¼ (10.8)	
			Cord tilt	3⅞ (9.1)	4⅞ (10.4)	
			Cordless cord tilt	3⅞ (8.1)	4⅞ (10.8)	

*Continuous valances wider than sizes shown above will have two or more sections spliced together with a keystone. Maximum width for spliced valances is 300¼" (764.0 cm).



[^]Keystones not available.

[†]Cordless lift not available.

General Information

Valance Returns: Horizontal Blinds

Returns for inside mount must be specified.

Valance Type	Blind Type	Maximum Continuous Width*		Control Type	Outside Mount inches (cm)	Full Recess Depth inches (cm)
		Inside Mount No Returns inches (cm)	Inside Mount with Returns inches (cm)			
3½" (8.9 cm) Craftsman Valance  Valance Returns ½" (1.3 cm) to 1" (2.6 cm): glued 1⅛" (2.7 cm) to 4⅝" (11.8 cm): optional glued 4⅞" (12.0 cm) and greater: not glued	1" (2.6 cm) Wood	100¼ (254.7)	98⅞ (249.9)	Wand tilt	2⅛ (5.3)	2⅝ (6.1)
	2" (5.1 cm) Wood 2" (5.1 cm) Elite Wood 2" (5.1 cm) Aluminum† 2" (5.1 cm) Vinyl†	100¼ (254.7)	98⅞ (249.9)	Cord tilt Wand tilt Cordless wand tilt Cordless cord tilt	2⅞ (7.4) 3⅞ (9.1) 3⅞ (8.6) 2¾ (7.0)	3¼ (8.3) 3⅞ (9.9) 3¼ (9.6) 3⅞ (7.8)
	2⅝" (6.1 cm) Wood 2⅝" (6.1 cm) Elite Wood	100¼ (254.7)	98⅞ (249.9)	Cord tilt Cordless wand tilt Cordless cord tilt	3¼ (9.6) 3⅞ (9.1) 3⅞ (9.1)	4⅞ (10.4) 3⅞ (10.1) 3⅞ (10.1)
	Wood Verticals	100¼ (254.7)	98⅞ (249.9)	N/A	5½ (14.0)	5⅞ (14.8)
3½" (8.9 cm) Legacy Valance  Valance Returns ½" (1.3 cm) to 1" (2.6 cm): glued 1⅛" (2.7 cm) to 4⅝" (11.8 cm): optional glued 4⅞" (12.0 cm) and greater: not glued	1" (2.6 cm) Wood	100¼ (254.7)	98⅞ (249.9)	Wand tilt	2⅛ (5.3)	2⅞ (6.2)
	2" (5.1 cm) Wood 2" (5.1 cm) Elite Wood 2" (5.1 cm) Aluminum† 2" (5.1 cm) Vinyl†	100¼ (254.7)	98⅞ (249.9)	Cord tilt Wand tilt Cordless wand tilt Cordless cord tilt	2⅞ (7.4) 3⅞ (9.1) 3⅞ (8.6) 2¾ (7.0)	3⅞ (8.5) 4 (10.2) 3⅞ (9.7) 3⅞ (8.0)
	2" (5.1 cm) Distressed Wood^ 2" (5.1 cm) Elite Authentic Hardwood^	100¼ (254.7)	98⅞ (249.9)	Cord tilt Wand tilt Cordless wand tilt Cordless cord tilt	2⅞ (7.4) 3⅞ (9.1) 3⅞ (8.6) 2¾ (7.0)	3⅞ (8.5) 4 (10.2) 3⅞ (9.7) 3⅞ (8.0)
	2⅝" (6.1 cm) Wood 2⅝" (6.1 cm) Elite Wood	100¼ (254.7)	98⅞ (249.9)	Cord tilt Cordless wand tilt Cordless cord tilt	3¼ (9.6) 3⅞ (9.1) 3⅞ (9.1)	4⅞ (10.7) 4⅞ (10.4) 4⅞ (10.4)
4½" (11.5 cm) Symphony Valance  Valance Returns ½" (1.3 cm) to 1" (2.6 cm): glued 1⅛" (2.7 cm) to 4⅝" (11.8 cm): optional glued 4⅞" (12.0 cm) and greater: not glued	1" (2.6 cm) Wood	100¼ (254.7)	98⅞ (249.9)	Wand tilt	2⅛ (5.3)	2⅞ (7.2)
	2" (5.1 cm) Wood 2" (5.1 cm) Elite Wood 2" (5.1 cm) Aluminum† 2" (5.1 cm) Vinyl†	100¼ (254.7)	98⅞ (249.9)	Cord tilt Wand tilt Cordless wand tilt Cordless cord tilt	2⅞ (7.4) 3⅞ (9.1) 3⅞ (8.6) 2¾ (7.0)	3⅞ (9.3) 4⅞ (11.0) 4⅞ (10.5) 3½ (8.9)
	2⅝" (6.1 cm) Wood 2⅝" (6.1 cm) Elite Wood	100¼ (254.7)	98⅞ (249.9)	Cord tilt Cordless wand tilt Cordless cord tilt	3¼ (9.6) 3⅞ (9.1) 3⅞ (9.1)	4½ (11.5) 4⅞ (11.0) 4⅞ (11.0)
	Wood Verticals	100¼ (254.7)	98⅞ (249.9)	N/A	5½ (14.0)	6¼ (15.9)

*Continuous valances wider than sizes shown above will have two or more sections spliced together with a keystone. Maximum width for spliced valances is 300¼" (764.0 cm).

^Keystones not available.

†Cordless lift not available.

General Information

Wood Valance Returns

Valance Type	Control Type	Classic Return Inside Width inches (cm)	Full Recess Depth inches (cm)
1" (2.6 cm) Wood Horizontal Blinds			
3" (7.7 cm) Classic Wood Valance	Wand tilt	2 ¹ / ₁₆ (5.3)	2 ⁵ / ₁₆ (6.1)
3 ¹ / ₂ " (8.9 cm) Craftsman Wood Valance	Wand tilt	2 ¹ / ₁₆ (5.3)	2 ⁵ / ₁₆ (6.1)
3 ¹ / ₂ " (8.9 cm) Legacy Wood Valance	Wand tilt	2 ¹ / ₁₆ (5.3)	2 ⁷ / ₁₆ (6.2)
4 ¹ / ₂ " (11.5 cm) Symphony Wood Valance	Wand tilt	2 ¹ / ₁₆ (5.3)	2 ¹ / ₁₆ (7.2)
2" (5.1 cm) Wood, Aluminum, and Vinyl Horizontal Blinds			
2 ¹ / ₂ " (6.4 cm) Classic Barnwood Valance [†]	Cord tilt	2 ⁷ / ₈ (7.4)	3 ¹ / ₄ (8.3)
	Wand tilt	3 ³ / ₁₆ (9.1)	3 ⁷ / ₈ (9.9)
	Cordless cord tilt	2 ³ / ₄ (7.0)	3 ¹ / ₁₆ (7.8)
	Cordless wand tilt	3 ³ / ₈ (8.6)	3 ³ / ₄ (9.6)
3" (7.7 cm) Classic Wood Valance*	Cord tilt	2 ⁷ / ₈ (7.4)	3 ¹ / ₄ (8.3)
	Wand tilt	3 ³ / ₁₆ (9.1)	3 ⁷ / ₈ (9.9)
	Cordless cord tilt	2 ³ / ₄ (7.0)	3 ¹ / ₁₆ (7.8)
	Cordless wand tilt	3 ³ / ₈ (8.6)	3 ³ / ₄ (9.6)
3 ¹ / ₂ " (8.9 cm) Craftsman Wood Valance*	Cord tilt	2 ⁷ / ₈ (7.4)	3 ¹ / ₄ (8.3)
	Wand tilt	3 ³ / ₁₆ (9.1)	3 ⁷ / ₈ (9.9)
	Cordless cord tilt	2 ³ / ₄ (7.0)	3 ¹ / ₁₆ (7.8)
	Cordless wand tilt	3 ³ / ₈ (8.6)	3 ³ / ₄ (9.6)
3 ¹ / ₂ " (8.9 cm) Legacy Wood Valance*	Cord tilt	2 ⁷ / ₈ (7.4)	3 ³ / ₁₆ (8.5)
	Wand tilt	3 ³ / ₁₆ (9.1)	4 (10.2)
	Cordless cord tilt	2 ³ / ₄ (7.0)	3 ¹ / ₈ (8.0)
	Cordless wand tilt	3 ³ / ₈ (8.6)	3 ¹ / ₁₆ (9.7)
4 ¹ / ₂ " (11.5 cm) Symphony Wood Valance*	Cord tilt	2 ⁷ / ₈ (7.4)	3 ⁵ / ₈ (9.3)
	Wand tilt	3 ³ / ₁₆ (9.1)	4 ⁷ / ₁₆ (11.0)
	Cordless cord tilt	2 ³ / ₄ (7.0)	3 ¹ / ₂ (8.9)
	Cordless wand tilt	3 ³ / ₈ (8.6)	4 ¹ / ₈ (10.5)
2³/₈" (6.1 cm) Wood Horizontal Blinds			
3" (7.7 cm) Classic Wood Valance	Cord tilt	3 ³ / ₄ (9.6)	4 ¹ / ₁₆ (10.4)
	Cordless cord tilt	3 ³ / ₁₆ (9.1)	3 ⁵ / ₁₆ (10.1)
	Cordless wand tilt	3 ³ / ₁₆ (9.1)	3 ⁵ / ₁₆ (10.1)
3 ¹ / ₂ " (8.9 cm) Craftsman Wood Valance	Cord tilt	3 ³ / ₄ (9.6)	4 ¹ / ₁₆ (10.4)
	Cordless cord tilt	3 ³ / ₁₆ (9.1)	3 ⁵ / ₁₆ (10.1)
	Cordless wand tilt	3 ³ / ₁₆ (9.1)	3 ⁵ / ₁₆ (10.1)
3 ¹ / ₂ " (8.9 cm) Legacy Wood Valance	Cord tilt	3 ³ / ₄ (9.6)	4 ³ / ₁₆ (10.7)
	Cordless cord tilt	3 ³ / ₁₆ (9.1)	4 ¹ / ₁₆ (10.4)
	Cordless wand tilt	3 ³ / ₁₆ (9.1)	4 ¹ / ₁₆ (10.4)
4 ¹ / ₂ " (11.5 cm) Symphony Wood Valance	Cord tilt	3 ³ / ₄ (9.6)	4 ¹ / ₂ (11.5)
	Cordless cord tilt	3 ³ / ₁₆ (9.1)	4 ⁹ / ₁₆ (11.0)
	Cordless wand tilt	3 ³ / ₁₆ (9.1)	4 ⁹ / ₁₆ (11.0)
Artisan Fabric Roman Shades			
3" (7.7 cm) Classic Wood Valance	Cord lift	4 ¹ / ₈ (10.5)	4 ³ / ₈ (11.2)
	Other lift types	4 ⁷ / ₈ (12.4)	5 ³ / ₁₆ (13.2)
3 ¹ / ₂ " (8.9 cm) Craftsman Wood Valance	Cord lift	4 ¹ / ₈ (10.5)	4 ³ / ₈ (11.2)
	Other lift types	4 ⁷ / ₈ (12.4)	5 ³ / ₁₆ (13.2)
3 ¹ / ₂ " (8.9 cm) Legacy Wood Valance	Cord lift	4 ¹ / ₈ (10.5)	4 ¹ / ₂ (11.5)
	Other lift types	4 ⁷ / ₈ (12.4)	5 ¹ / ₄ (13.4)
4 ¹ / ₂ " (11.5 cm) Symphony Wood Valance	Cord lift	4 ¹ / ₈ (10.5)	4 ⁷ / ₈ (12.4)
	Other lift types	4 ⁷ / ₈ (12.4)	5 ⁵ / ₈ (14.3)

*Cordless lift not available with 2" (5.1 cm) aluminum or vinyl blinds.

†Only available with 2" (5.1 cm) barnwood blinds.

NOTE: Minimum return width is 1/2" (1.3 cm); maximum return width is 8" (20.4 cm). Valance returns 1/2" (1.3 cm) to 1" (2.6 cm) will be glued, 1 1/16" (2.7 cm) to 4 3/8" (11.8 cm) will be optional glued, 4 1/16" (12.0 cm) and greater cannot be glued.

Valances only available on bay or corner windows if bay or corner application is available on entire product line selected. See price list of product selected for measuring instructions. If the valance is to be used alone (no product selected), the return width must be specified at the time of the order.

General Information

Wood Valance Returns

Valance Type	Control Type	Classic Return Inside Width inches (cm)	Full Recess Depth inches (cm)
Cellular, Pleated, Fresco Roman, Solar, and Roller Shades			
3" (7.7 cm) Classic Wood Valance	All	3¾ (9.6)	4¼ (10.4)
3½" (8.9 cm) Craftsman Wood Valance	All	3¾ (9.6)	4¼ (10.4)
3½" (8.9 cm) Legacy Wood Valance	All	3¾ (9.6)	4½ (10.5)
4½" (11.5 cm) Symphony Wood Valance	All	3¾ (9.6)	4½ (11.5)
Cellular Shade Vertical Application			
3" (7.7 cm) Classic Wood Valance	All	3⅞ (8.0)	3⅞ (8.8)
3½" (8.9 cm) Craftsman Wood Valance	All	3⅞ (8.0)	3⅞ (8.8)
3½" (8.9 cm) Legacy Wood Valance	All	3⅞ (8.0)	3½ (8.9)
4½" (11.5 cm) Symphony Wood Valance	All	3⅞ (8.0)	3⅞ (9.9)
Dual Shades			
3" (7.7 cm) Classic Wood Valance*	All	5½ (14.0)	5⅞ (14.8)
3½" (8.9 cm) Craftsman Wood Valance*	All	5½ (14.0)	5⅞ (14.8)
3½" (8.9 cm) Legacy Wood Valance*	All	5½ (14.0)	5⅞ (15.0)
4½" (11.5 cm) Symphony Wood Valance	All	5½ (14.0)	6¼ (15.9)
Natural Drapes			
3" (7.7 cm) Classic Wood Valance	All	6 (15.3)	6⅞ (16.1)
3½" (8.9 cm) Craftsman Wood Valance	All	6 (15.3)	6⅞ (16.1)
3½" (8.9 cm) Legacy Wood Valance	All	6 (15.3)	6⅞ (16.2)
4½" (11.5 cm) Symphony Wood Valance	All	6 (15.3)	6¾ (17.2)
Natural Shades			
3" (7.7 cm) Classic Wood Valance	All	3⅞ (9.3)	3⅞ (10.1)
3½" (8.9 cm) Craftsman Wood Valance	All	3⅞ (9.3)	3⅞ (10.1)
3½" (8.9 cm) Legacy Wood Valance	All	3⅞ (9.3)	4¼ (10.4)
4½" (11.5 cm) Symphony Wood Valance	All	3⅞ (9.3)	4¾ (11.2)
Sheer Vertical Blinds			
3" (7.7 cm) Classic Wood Valance	All	6¼ (15.9)	6⅞ (16.7)
3½" (8.9 cm) Craftsman Wood Valance	All	6¼ (15.9)	6⅞ (16.7)
3½" (8.9 cm) Legacy Wood Valance	All	6¼ (15.9)	6⅞ (16.9)
4½" (11.5 cm) Symphony Wood Valance	All	6¼ (15.9)	7 (17.8)
Sliding Panels			
3" (7.7 cm) Classic Wood Valance	All	5 (12.7)	5⅞ (13.5)
3½" (8.9 cm) Craftsman Wood Valance	All	5 (12.7)	5⅞ (13.5)
3½" (8.9 cm) Legacy Wood Valance	All	5 (12.7)	5⅞ (13.7)
4½" (11.5 cm) Symphony Wood Valance	All	5 (12.7)	5¾ (14.7)
Vertical Blinds			
3" (7.7 cm) Classic Wood Valance	All	5½ (14.0)	5⅞ (14.8)
3½" (8.9 cm) Craftsman Wood Valance	All	5½ (14.0)	5⅞ (14.8)
3½" (8.9 cm) Legacy Wood Valance	All	5½ (14.0)	5⅞ (15.0)
4½" (11.5 cm) Symphony Wood Valance	All	5½ (14.0)	6¼ (15.9)

*Symphony valance recommended for better coverage.

NOTE: Minimum return width is ½" (1.3 cm); maximum return width is 8" (20.4 cm). Valance returns ½" (1.3 cm) to 1" (2.6 cm) will be glued, 1¼" (2.7 cm) to 4⅞" (11.8 cm) will be optional glued, 4⅞" (12.0 cm) and greater cannot be glued.

Valances only available on bay or corner windows if bay or corner application is available on entire product line selected. See price list of product selected for measuring instructions. If the valance is to be used alone (no product selected), the return width must be specified at the time of the order.

General Information

Wood Cornice Returns

Valance Type	Control Type	Standard Return Inside Width inches (cm)	Full Recess Depth inches (cm)
1" (2.6 cm) Wood Horizontal Blinds			
4½" (11.5 cm) Symphony Wood Cornice	All	3⅞ (9.3)	4⅞ (11.3)
5½" (14.0 cm) Noble Wood Cornice	All	3⅞ (9.3)	4⅞ (11.8)
7½" (19.1 cm) Noble Wood Cornice	All	3⅞ (9.3)	4⅞ (12.6)
5½" (14.0 cm) Regal Wood Cornice	All	3⅞ (9.3)	5⅞ (12.9)
7½" (19.1 cm) Regal Wood Cornice	All	3⅞ (9.3)	5⅞ (14.3)
2" (5.1 cm) Wood, Aluminum, and Vinyl Horizontal Blinds			
4½" (11.5 cm) Symphony Wood Cornice	All	5 (12.7)	5⅞ (14.8)
5½" (14.0 cm) Noble Wood Cornice	All	5 (12.7)	6 (15.3)
7½" (19.1 cm) Noble Wood Cornice	All	5 (12.7)	6⅞ (16.1)
5½" (14.0 cm) Regal Wood Cornice	All	5 (12.7)	6⅞ (16.4)
7½" (19.1 cm) Regal Wood Cornice	All	5 (12.7)	7 (17.8)
2⅜" (6.1 cm) Wood Horizontal Blinds			
4½" (11.5 cm) Symphony Wood Cornice	All	5 (12.7)	5⅞ (14.8)
5½" (14.0 cm) Noble Wood Cornice	All	5 (12.7)	6 (15.3)
7½" (19.1 cm) Noble Wood Cornice	All	5 (12.7)	6⅞ (16.1)
5½" (14.0 cm) Regal Wood Cornice	All	5 (12.7)	6⅞ (16.4)
7½" (19.1 cm) Regal Wood Cornice	All	5 (12.7)	7 (17.8)
Artisan Fabric Roman Shades			
4½" (11.5 cm) Symphony Wood Cornice	Cord lift	4⅞ (10.5)	4⅞ (12.6)
	Other lift types	4⅞ (12.4)	5⅞ (14.5)
5½" (14.0 cm) Noble Wood Cornice	Cord lift	4⅞ (10.5)	5⅞ (13.1)
	Other lift types	4⅞ (12.4)	5⅞ (15.0)
7½" (19.1 cm) Noble Wood Cornice	Cord lift	4⅞ (10.5)	5⅞ (13.9)
	Other lift types	4⅞ (12.4)	6⅞ (15.8)
5½" (14.0 cm) Regal Wood Cornice	Cord lift	4⅞ (10.5)	5⅞ (14.2)
	Other lift types	4⅞ (12.4)	6⅞ (16.1)
7½" (19.1 cm) Regal Wood Cornice	Cord lift	4⅞ (10.5)	6⅞ (15.6)
	Other lift types	4⅞ (12.4)	6⅞ (17.5)
Cellular, Pleated, Fresco Roman, Solar, and Roller Shades			
4½" (11.5 cm) Symphony Wood Cornice	All	3¾ (9.6)	4⅞ (11.6)
5½" (14.0 cm) Noble Wood Cornice	All	3¾ (9.6)	4⅞ (12.1)
7½" (19.1 cm) Noble Wood Cornice	All	3¾ (9.6)	5⅞ (12.9)
5½" (14.0 cm) Regal Wood Cornice	All	3¾ (9.6)	5⅞ (13.2)
7½" (19.1 cm) Regal Wood Cornice	All	3¾ (9.6)	5⅞ (14.7)
Cellular Shade Vertical Application			
4½" (11.5 cm) Symphony Wood Cornice	All	3⅞ (8.0)	3⅞ (10.1)
5½" (14.0 cm) Noble Wood Cornice	All	3⅞ (8.0)	4⅞ (10.5)
7½" (19.1 cm) Noble Wood Cornice	All	3⅞ (8.0)	4⅞ (11.3)
5½" (14.0 cm) Regal Wood Cornice	All	3⅞ (8.0)	4⅞ (11.6)
7½" (19.1 cm) Regal Wood Cornice	All	3⅞ (8.0)	5⅞ (13.1)

NOTE: Dual shades can be configured with 7½" (19.1 cm) cornices. 5½" (14.0 cm) cornices are available only when dual shade has no cassette with inside mount and cornices are outside mount.

Minimum return width is ½" (1.3 cm); maximum return width is 8" (20.4 cm).

Cornices are not available on bay or corner windows. If the cornice is to be used alone (no product selected), the return width must be specified at the time of the order.

General Information

Wood Cornice Returns

Dual Shades

4½" (11.5 cm) Symphony Wood Cornice	All	5½ (14.0)	6⅞ (16.1)
5½" (14.0 cm) Noble Wood Cornice	All	5½ (14.0)	6½ (16.6)
7½" (19.1 cm) Noble Wood Cornice	All	5½ (14.0)	6⅜ (17.4)
5½" (14.0 cm) Regal Wood Cornice	All	5½ (14.0)	6⅞ (17.7)
7½" (19.1 cm) Regal Wood Cornice	All	5½ (14.0)	7½ (19.1)

Natural Drapes

4½" (11.5 cm) Symphony Wood Cornice	All	6 (15.3)	6⅞ (17.4)
5½" (14.0 cm) Noble Wood Cornice	All	6 (15.3)	7 (17.8)
7½" (19.1 cm) Noble Wood Cornice	All	6 (15.3)	7⅞ (18.6)
5½" (14.0 cm) Regal Wood Cornice	All	6 (15.3)	7⅞ (18.9)
7½" (19.1 cm) Regal Wood Cornice	All	6 (15.3)	8 (20.4)

Natural Shades

4½" (11.5 cm) Symphony Wood Cornice	All	3⅝ (9.3)	4⅞ (11.3)
5½" (14.0 cm) Noble Wood Cornice	All	3⅝ (9.3)	4⅝ (11.8)
7½" (19.1 cm) Noble Wood Cornice	All	3⅝ (9.3)	4⅝ (12.6)
5½" (14.0 cm) Regal Wood Cornice	All	3⅝ (9.3)	5⅞ (12.9)
7½" (19.1 cm) Regal Wood Cornice	All	3⅝ (9.3)	5⅞ (14.3)

Sheer Vertical Blinds

4½" (11.5 cm) Symphony Wood Cornice	All	6¼ (15.9)	7⅞ (18.0)
5½" (14.0 cm) Noble Wood Cornice	All	6¼ (15.9)	7¼ (18.5)
7½" (19.1 cm) Noble Wood Cornice	All	6¼ (15.9)	7⅞ (19.3)
5½" (14.0 cm) Regal Wood Cornice	All	6¼ (15.9)	7⅞ (19.6)
7½" (19.1 cm) Regal Wood Cornice	All	6¼ (15.9)	8¼ (21.0)

Sliding Panels

4½" (11.5 cm) Symphony Wood Cornice	All	5 (12.7)	5⅞ (14.8)
5½" (14.0 cm) Noble Wood Cornice	All	5 (12.7)	6 (15.3)
7½" (19.1 cm) Noble Wood Cornice	All	5 (12.7)	6⅞ (16.1)
5½" (14.0 cm) Regal Wood Cornice	All	5 (12.7)	6⅞ (16.4)
7½" (19.1 cm) Regal Wood Cornice	All	5 (12.7)	7 (17.8)

Vertical Blinds

4½" (11.5 cm) Symphony Wood Cornice	All	5½ (14.0)	6⅞ (16.1)
5½" (14.0 cm) Noble Wood Cornice	All	5½ (14.0)	6½ (16.6)
7½" (19.1 cm) Noble Wood Cornice	All	5½ (14.0)	6⅜ (17.4)
5½" (14.0 cm) Regal Wood Cornice	All	5½ (14.0)	6⅞ (17.7)
7½" (19.1 cm) Regal Wood Cornice	All	5½ (14.0)	7½ (19.1)

NOTE: Minimum return width is ½" (1.3 cm); maximum return width is 8" (20.4 cm).

Cornices are not available on bay or corner windows. If the cornice is to be used alone (no product selected), the return width must be specified at the time of the order.

General Information

Composite and Faux Wood Valance Returns

Valance Type	Control Type	Standard Return Inside Width inches (cm)	Full Recess Depth inches (cm)
2" (5.1 cm) Composite and Faux Wood Horizontal Blinds			
3" (7.7 cm) Classic Composite or Faux Wood Valance	Cord tilt	2 ⁷ / ₈ (7.4)	3 ¹ / ₄ (8.3)
	Wand tilt	3 ³ / ₈ (9.1)	3 ⁷ / ₈ (9.9)
	Cordless cord tilt	2 ³ / ₄ (7.0)	3 ¹ / ₈ (7.8)
	Cordless wand tilt	3 ³ / ₈ (8.6)	3 ³ / ₄ (9.6)
3" (7.7 cm) Majestic Composite or Faux Wood Valance	Cord tilt	2 ⁷ / ₈ (7.4)	3 ³ / ₈ (8.6)
	Wand tilt	3 ³ / ₈ (9.1)	4 ¹ / ₈ (10.4)
	Cordless cord tilt	2 ³ / ₄ (7.0)	3 ³ / ₈ (8.1)
	Cordless wand tilt	3 ³ / ₈ (8.6)	3 ⁷ / ₈ (9.9)
2¹/₂" (6.4 cm) Composite and Faux Wood Horizontal Blinds			
3" (7.7 cm) Classic Composite or Faux Wood Valance	Cord tilt	3 ¹⁵ / ₁₆ (10.1)	4 ¹ / ₄ (10.8)
	Cordless cord tilt	3 ³ / ₄ (9.6)	4 ⁷ / ₈ (10.5)
	Cordless wand tilt	3 ³ / ₄ (9.6)	4 ⁷ / ₈ (10.5)
3" (7.7 cm) Majestic Composite or Faux Wood Valance	Cord tilt	3 ¹⁵ / ₁₆ (10.1)	4 ⁷ / ₈ (11.3)
	Cordless cord tilt	3 ³ / ₄ (9.6)	4 ¹ / ₄ (10.8)
	Cordless wand tilt	3 ³ / ₄ (9.6)	4 ¹ / ₄ (10.8)
Artisan Fabric Roman Shades			
3" (7.7 cm) Classic Composite or Faux Wood Valance	Cord lift	4 ¹ / ₈ (10.5)	4 ³ / ₈ (11.2)
	Other lift types	4 ⁷ / ₈ (12.4)	5 ¹ / ₈ (13.2)
3" (7.7 cm) Majestic Composite or Faux Wood Valance	Cord lift	4 ¹ / ₈ (10.5)	4 ³ / ₈ (11.6)
	Other lift types	4 ⁷ / ₈ (12.4)	5 ¹ / ₈ (13.5)
Cellular, Pleated, Fresco Roman, Solar, and Roller Shades			
3" (7.7 cm) Classic Composite or Faux Wood Valance	All	3 ³ / ₄ (9.6)	4 ¹ / ₈ (10.4)
3" (7.7 cm) Majestic Composite or Faux Wood Valance	All	3 ³ / ₄ (9.6)	4 ¹ / ₈ (10.7)
Cellular Shade Vertical Application			
3" (7.7 cm) Classic Composite or Faux Wood Valance	All	3 ¹ / ₈ (8.0)	3 ¹ / ₈ (8.8)
3" (7.7 cm) Majestic Composite or Faux Wood Valance	All	3 ¹ / ₈ (8.0)	3 ³ / ₈ (9.1)
Dual Shades			
3" (7.7 cm) Classic Composite or Faux Wood Valance*	All	5 ¹ / ₂ (14.0)	5 ¹³ / ₁₆ (14.8)
3" (7.7 cm) Majestic Composite or Faux Wood Valance*	All	5 ¹ / ₂ (14.0)	5 ¹¹ / ₁₆ (15.1)
Natural Drapes			
3" (7.7 cm) Classic Composite or Faux Wood Valance	All	6 (15.3)	6 ¹ / ₈ (16.1)
3" (7.7 cm) Majestic Composite or Faux Wood Valance	All	6 (15.3)	6 ¹ / ₈ (16.4)
Natural Shades			
3" (7.7 cm) Classic Composite or Faux Wood Valance	All	3 ³ / ₈ (9.3)	3 ¹⁵ / ₁₆ (10.1)
3" (7.7 cm) Majestic Composite or Faux Wood Valance	All	3 ³ / ₈ (9.3)	4 ¹ / ₈ (10.4)
Sheer Vertical Blinds			
3" (7.7 cm) Classic Composite or Faux Wood Valance	All	6 ¹ / ₄ (15.9)	6 ¹ / ₈ (16.7)
3" (7.7 cm) Majestic Composite or Faux Wood Valance	All	6 ¹ / ₄ (15.9)	6 ¹¹ / ₁₆ (17.0)
Sliding Panels			
3" (7.7 cm) Classic Composite or Faux Wood Valance	All	5 (12.7)	5 ⁵ / ₈ (13.5)
3" (7.7 cm) Majestic Composite or Faux Wood Valance	All	5 (12.7)	5 ³ / ₈ (13.9)
Vertical Blinds			
3" (7.7 cm) Classic Composite or Faux Wood Valance	All	5 ¹ / ₂ (14.0)	5 ¹³ / ₁₆ (14.8)
3" (7.7 cm) Majestic Composite or Faux Wood Valance	All	5 ¹ / ₂ (14.0)	5 ¹¹ / ₁₆ (15.1)

*Faux wood and composite valances not recommended due to valance heights.

NOTE: Minimum return width is 1/2" (1.3 cm); maximum return width is 8" (20.4 cm). Valance returns 1/2" (1.3 cm) to 1" (2.6 cm) will be glued, 1 1/8" (2.7 cm) to 4 5/8" (11.8 cm) will be optional glued, 4 11/16" (12.0 cm) and greater cannot be glued.

Valances only available on bay or corner windows if bay or corner application is available on entire product line selected. See price list of product selected for measuring instructions. If the valance is to be used alone (no product selected), the return width must be specified at the time of the order.

General Information

How to Measure for Valance Returns

Window depths vary considerably depending on the age and style of the window.

Always measure the window depth, regardless of the type of window treatment the client is considering. Knowing the depth when the order is placed can help prevent costly errors.

Use the information in your price list for wood, composite, and faux wood to calculate the needed return width (see previous pages).

To calculate the return width, use this formula:

[standard return width] minus [client window depth] =
special return length to order for inside mount blind

REMEMBER:

- Smallest return width is $\frac{1}{2}$ " (1.3 cm) (inside measurement)
- Returns $\frac{1}{2}$ " (1.3 cm) to 1" (2.6 cm) (inside measurement) will be glued;
- returns $1\frac{1}{16}$ " (2.7 cm) to $4\frac{5}{16}$ " (11.8 cm) (inside measurement) have the option of being glued
- The width of a return and the width of a valance are measured on the inside (back side) of the valance, not the outside (face) of the valance (see diagram at right)
- Standard return size for $2\frac{3}{8}$ " (6.1 cm) blinds—
subtract $\frac{3}{16}$ " (0.5 cm) prior to determining special return width
- Standard return size for $2\frac{1}{2}$ " (6.4 cm) blinds—
subtract $\frac{3}{8}$ " (1.0 cm) prior to determining special return width

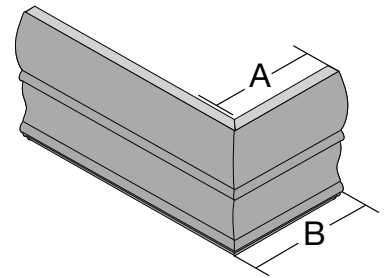

A: Inside Measurement
B: Outside Measurement

General Information

How to Measure and Order Cornices and Valances

Wood cornices and valances are optional with your custom order or as a stand-alone order.

NOTE: Cornices and valances with returns are measured and cut from the **INSIDE** of the miter to ensure the most accurate fit when installed over the headrail or window frame.

Outside Mount

- Cornices and valances are supplied with returns sized to cover the end of the blinds back to the mounting surface
- Custom returns may be ordered up to 8" (20.4 cm), minimum return is ½" (1.3 cm)
- Cornices include a dust cover to conceal the top of the blind

Inside Mount

- Cornices and valances are supplied without returns and look best when the blinds and valance or cornice can be completely recessed
- Ends of the valance and cornice are straight-cut
- Cornices do NOT have a dust cover and returns are NOT available
- Returns for inside mount valances must be specified

Additional Ordering Information

- Please state at the time of order if the valance or cornice return measurements are for the **EXACT** size required so that no additions or deductions are made
- Cornices and valances will be shipped separately from blind
- Manufacturer recommends installing blind and valance/cornice at the same time

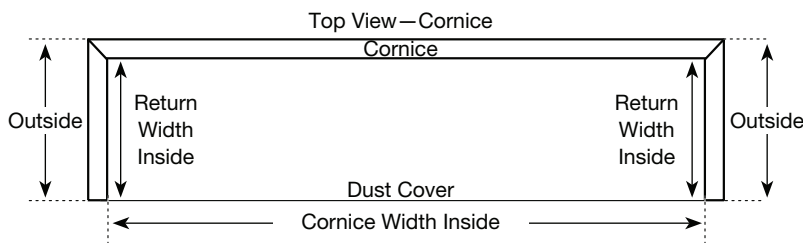

Side View—Cornice

1. Full recess is from front of cornice to wall.
2. Return width is from miter to wall.

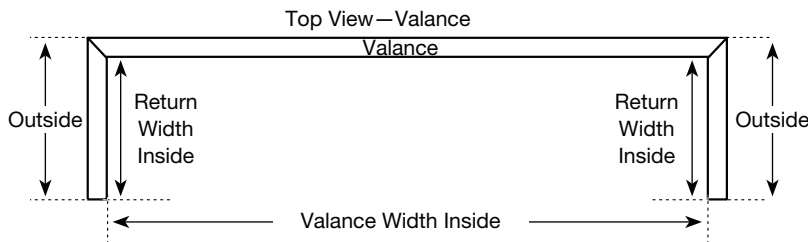
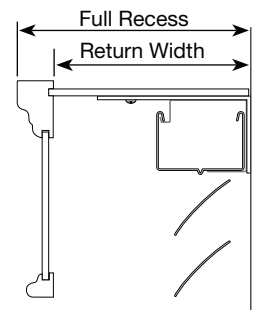

Side View—Valance

1. Full recess is from front of valance to wall.
2. Return width is from miter to wall.
3. Partial recess—subtract actual window recess from return width to arrive at exact return width.

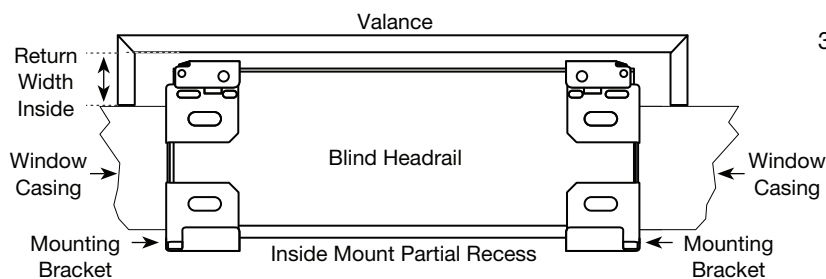
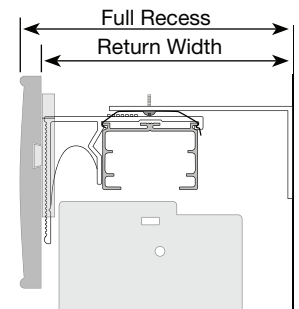

General Information

How to Measure a Special Splice Location

A keystone is supplied for valance and cornice widths that require a splice. Keystone will be equally spaced unless a special splice location is requested at time of order. The placement of the splice will be calculated by the factory using an INSIDE measurement from the mitered corner to the location specified on the order.

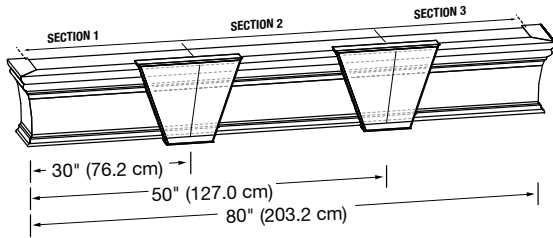

Each splice location should be recorded starting from the LEFT BACKSIDE corner.

EXAMPLE: Overall valance width = 80" (203.2 cm) backside measurement
First splice from left = 30" (76.2 cm) backside measurement
Second splice from left = 50" (127.0 cm) backside measurement

See size considerations for cornice and valance manufacturing formulas to determine exact back width size your cornice or valance will be prior to selecting splice locations.

For keystone pricing, see pricing pages.

NOTE: All measurements need to be from backside.

Custom Color

Graber® offers the unique option of custom color in either paint or stain. Use the following guidelines when placing your order.

With your order, please send a color chip (at least a 2" (5.1 cm) square sample) with the color name on the sample. A sample of the color can be requested before blinds are manufactured for your approval. An approval color sample will be automatically sent on orders for six or more blinds. A customer may waive their sample if they do not wish to receive one. Samples usually add approximately two (2) weeks to the lead time of an order. If a color sample is not requested, the sample you provided will be used to manufacture the wood blinds. If the color chip is to be returned to you, please note this on your order.

Please send all color chips to:

Springs Window Fashions, LLC
ATTN: Graber Custom Color
33 West 3rd Street, Suite 400
Williamsport, PA 17701

NOTE: Due to the nature of the custom color process, manufacturing requires an extended lead time. The standard manufacturing process does not apply. Lead-times vary depending on sizes and quantities ordered.

General Information

Mounting Brackets

Universal Cornice Mounting Bracket

- L-brackets
- Standard when ordered with
 - Any inside mount cornice
 - Outside mount cornice with returns greater than 1 3/4" (4.5 cm)

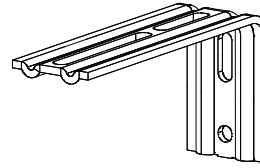

L-Bracket

Short Return Cornice Mounting Bracket

- Bracket and hanger
- Standard when ordered with
 - Outside mount cornice with return width 1/2" (1.3 cm) to 1 3/4" (4.5 cm)

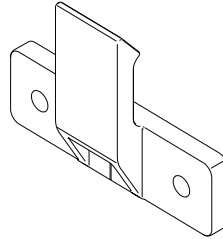

Hanger

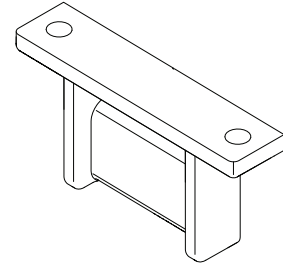

Bracket

Universal Valance Mounting Bracket

- Standard when ordered for any of the following products
 - Cellular, pleated, soft, artisan fabric Roman, fresco Roman, solar, and roller shades
 - Cellular shade vertical application
 - Dual shades
 - Sliding panels
 - Sheer vertical blinds
 - Vertical blinds
 - Natural shades or drapes
 - Other or alone

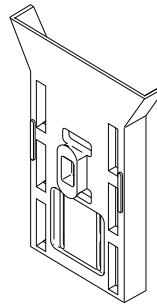

Valance Slide

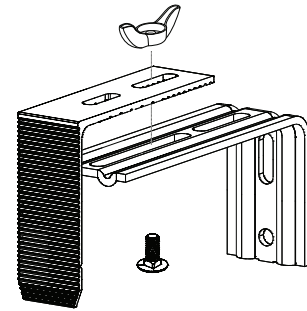

Horizontal Valance Mounting Bracket

- Clip and slide brackets
- Projection width depends on slat size and control type selected
- Standard when ordered for any of the following products
 - 2" (5.1 cm) aluminum horizontal blinds
 - 2" (5.1 cm) and 2 1/2" (6.4 cm) faux wood blinds
 - 2" (5.1 cm) vinyl horizontal blinds
 - 1" (2.6 cm), 2" (5.1 cm), and 2 3/8" (6.1 cm) wood blinds

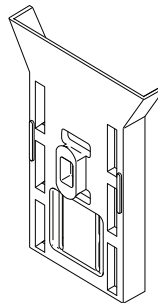

Valance Slide

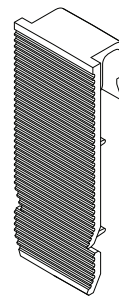

Short Valance Clip
(Available with 1" (2.6 cm), 2" (5.1 cm) cord tilt, or motorized tilt)

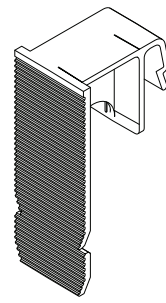

Long Valance Clip
(Available with wand tilt or slat sizes greater than 2" (5.1 cm))

Price Charts

Wood Cornice Pricing

Width up to inches (cm) →	23 (58.5)	30 (76.2)	36 (91.5)	42 (106.7)	48 (122.0)	54 (137.2)	60 (152.4)	66 (167.7)	72 (182.9)	78 (198.2)	84 (213.4)	90 (228.6)	96 (243.9)	106 (269.3)	116 (294.7)
4½" (11.5 cm) Symphony Wood Cornice*	\$215	232	242	254	276	298	324	332	340	353	376	380	604	622	639
5½" (14.0 cm) Regal Wood Cornice	270	287	298	319	340	362	389	404	418	432	474	480	723	746	768
7½" (19.1 cm) Regal Wood Cornice	346	366	378	397	416	432	449	469	479	505	542	581	864	895	924
5½" (14.0 cm) Noble Wood Cornice	226	244	256	274	298	319	346	360	371	383	410	416	656	676	695
7½" (19.1 cm) Noble Wood Cornice	321	344	358	372	385	401	418	432	447	479	524	563	846	871	899

Width up to inches (cm) →	126 (320.1)	136 (345.5)	146 (370.9)	156 (396.3)	166 (421.7)	176 (447.1)	186 (472.5)	192 (487.7)	216 (548.7)	240 (609.6)	264 (670.6)	283 (718.9)	312* (792.5)	336 (853.5)	366 (929.7)
4½" (11.5 cm) Symphony Wood Cornice*	\$654	673	690	707	723	741	757	991	1006	1041	1076	1110	1360		
5½" (14.0 cm) Regal Wood Cornice	789	812	834	857	879	902	924	1183	1206	1250	1295	1340	1622	1666	1711
7½" (19.1 cm) Regal Wood Cornice	955	986	1016	1047	1078	1109	1139	1416	1445	1509	1569	1630	1938	1999	2059
5½" (14.0 cm) Noble Wood Cornice	711	731	750	768	786	805	823	1077	1094	1132	1170	1206	1478	1515	1551
7½" (19.1 cm) Noble Wood Cornice	924	952	978	1006	1032	1059	1085	1356	1384	1437	1490	1543	1842	1894	1948

*Maximum width 300¾" (764.0 cm).

NOTE: Includes returns (if requested) and mounting hardware.
Minimum width 8" (20.4 cm) exact.

Decorative Cornice Keystone Pricing

- Keystones are included in the price of a spliced cornice; additional keystones are available as a surcharge
- Surcharge
 - 7½" (19.1 cm) noble and regal: \$213 each
 - 5½" (14.0 cm) noble and regal: \$204 each
 - 4½" (11.5 cm) symphony: \$180 each
- Maximum keystones on single piece cornice is 3

Custom Color Pricing

- Custom color pricing: \$149 net surcharge per color

Price Charts

Wood Valance Pricing

Width up to inches (cm) →	24 (61.0)	32 (81.3)	36 (91.5)	42 (106.7)	48 (122.0)	54 (137.2)	60 (152.4)	66 (167.7)	72 (182.9)	78 (198.2)	84 (213.4)	90 (228.6)	96 (243.9)	106 (269.3)	116 (294.7)	126 (320.1)	136 (345.5)
3" (7.7 cm) Classic Wood Valance	\$38	47	53	59	63	65	74	81	85	90	97	101	105	118	130	139	148
3½" (8.9 cm) Craftsman Wood Valance	40	49	57	61	65	74	77	83	89	93	101	103	108	121	133	142	151
3½" (8.9 cm) Legacy Wood Valance	40	49	57	61	65	74	77	83	89	93	101	103	108	121	133	142	151
4½" (11.5 cm) Symphony Wood Valance	48	54	62	66	74	81	85	90	94	102	104	109	119	136	146	158	168

Width up to inches (cm) →	146 (370.9)	156 (396.3)	166 (421.7)	176 (447.1)	186 (472.5)	196 (497.9)	206 (523.3)	216 (548.7)	226 (574.1)	236 (599.5)	246 (624.9)	256 (650.3)	266 (675.7)	276 (701.1)	286 (726.5)	296 (751.9)	300 (762.0)
3" (7.7 cm) Classic Wood Valance	\$159	168	177	188	198	207	217	226	238	247	256	267	276	286	296	306	315
3½" (8.9 cm) Craftsman Wood Valance	162	171	181	191	201	211	220	231	241	250	259	270	279	289	300	309	319
3½" (8.9 cm) Legacy Wood Valance	162	171	181	191	201	211	220	231	241	250	259	270	279	289	300	309	319
4½" (11.5 cm) Symphony Wood Valance	179	190	201	212	222	234	245	255	267	277	288	300	310	321	332	343	354

NOTE: Includes returns (if requested) and mounting hardware.
Minimum width 8" (20.4 cm) exact. Maximum width 300¾" (764.0 cm).

Decorative Wood Valance Keystone Pricing

- Keystones are included in the price of a spliced valance; additional keystones are available as a surcharge
- Surcharge
 - 3" (7.7 cm) classic wood valance: \$22 each
 - 3½" (8.9 cm) craftsman wood valance: \$22 each
 - 3½" (8.9 cm) legacy wood valance: \$22 each
 - 4½" (11.5 cm) symphony wood valance: \$22 each
- Maximum keystones on a single valance is 3

Custom Color Pricing

- Custom color pricing: \$149 net surcharge per color

Composite and Faux Wood Valance Pricing

Width up to inches (cm) →	24 (61.0)	32 (81.3)	36 (91.5)	42 (106.7)	48 (122.0)	54 (137.2)	60 (152.4)	66 (167.7)	72 (182.9)	78 (198.2)	84 (213.4)	90 (228.6)	96 (243.9)	106 (269.3)	116 (294.7)	126 (320.1)	136 (345.5)
3" (7.7 cm) Classic Composite and Faux Wood Valance	\$32	36	42	46	51	56	60	64	69	74	80	85	90	98	106	114	123
3" (7.7 cm) Majestic Composite and Faux Wood Valance	38	46	53	58	62	68	70	77	83	87	95	97	102	111	120	131	140

Width up to inches (cm) →	146 (370.9)	156 (396.3)	166 (421.7)	176 (447.1)	186 (472.5)	196 (497.9)	206 (523.3)	216 (548.7)	226 (574.1)	236 (599.5)	246 (624.9)	256 (650.3)	266 (675.7)	276 (701.1)	286 (726.5)	296 (751.9)	300 (762.0)
3" (7.7 cm) Classic Composite and Faux Wood Valance	\$132	140	148	156	165	173	182	190	199	207	215	223	233	241	249	257	266
3" (7.7 cm) Majestic Composite and Faux Wood Valance	149	159	168	177	187	197	206	215	224	235	244	253	263	272	282	291	301

NOTE: Includes returns (if requested) and mounting hardware.
Minimum width 8" (20.4 cm) exact. Maximum width 300¾" (764.0 cm).
Spliced faux wood valances not available with keystones.

Palladian Window Shelf Pricing

Width up to inches (cm) →	24 (61.0)	32 (81.3)	36 (91.5)	42 (106.7)	48 (122.0)	54 (137.2)	60 (152.4)	66 (167.7)	72 (182.9)	78 (198.2)	84 (213.4)	90 (228.6)	96 (243.9)
Palladian Window Shelf	\$80	106	119	140	160	180	200	219	240	259	279	300	319

NOTE: Minimum width 7" (17.8 cm) exact.



Grabber is a brand of Springs Window Fashions, the Best Experience Company 

Grabber and the Grabber logo are registered trademarks of Springs Window Fashions, LLC.

19-0429-09 (04/18) 17-7526|S17-7287