



PerfectSheer™ & SmartDrape™ Shades

PROGRAM REFERENCE GUIDE



Date	Program	Revision
4/15/2022	SmartDrape™	Pg. 28: Optional Long L bracket available.
5/3/2022	SmartDrape™	Pg. 28: Optional Keystone for all Side by Side shades is available.
6/3/2022	SmartDrape™	Pg. 33: Added SmartDrape™ disclaimer
8/1/2022	SmartDrape™	<p><i>NEW!</i> SmartDrape fabrics available August 1st</p> <p>Pg. 28: Updated aluminum shim / L bracket quantity</p> <p>Pg. 31: Added new fabrics</p>
1/1/2023	PerfectSheer™	<p><u>General Update:</u> Discontinued 25CE/25TE/35E motor options for PerfectSheer™ shades. See dedicated 2023 motorization specifications for additional details.</p> <p>Pg. 4,11: Updated minimum width for motorized shades</p>
1/1/2023	SmartDrape™	<p><u>General Update:</u> Increased SmartDrape max width. Track widths now extend up to 189 5/8" for single tracks, and 188 1/8" + 188 1/8" for side by side tracks.</p> <p>Pg. 21: Updated SmartDrape max width</p> <p>Pg. 22-23: Added new SmartDrape track sizes and shade configurations</p> <p>Pg. 27: Updated Aluminum Shim/Bracket info</p>
2/15/2023	SmartDrape™	<p>Pg. 30: Updated the default hardware color from Crema</p> <p>Pg. 31: Long L Brackets are now available in the color Light Bronze</p> <p>Pg. 32: Added notes to fabric Disclaimers</p>
8/1/2023	PerfectSheer™	Pg. 18: Added Side by Side tolerance note
	SmartDrape™	<p><u>General Update:</u> Increased SmartDrape max width. Track widths now extend up to 285 5/8" for single tracks, and 284 3/8" + 284 3/8" for side by side tracks.</p> <p>Pg. 20-23: Added new track sizes & updated shade configurations</p> <p>Pg. 27: Updated hardware quantity</p>
9/25/2023	PerfectSheer™	Pg. 12: Revised Shim quantity info
Effective 1/1/2024	SmartDrape™	<p><u>General Update:</u> -NEW Essentials Collection Available: Lakeshore Stripe Pattern -Light Bronze hardware color discontinued</p> <p>Pg 29: Revised Alternating Vanes options</p> <p>Pg. 30: Add 3 new fabrics & updated default rail color for F1171 Coffee</p> <p>Pg. 31: Removed Light Bronze</p>



	Page
PerfectSheer™ Shades	
General Specifications	4
Lift Systems & Terminology	5 – 7
Top Treatments	7 – 8
Mounting Requirements & Fabric Deductions	9 – 11
Additional Options	12 – 13
Fabric List & Color Coordination	14
PerfectSheer Shades Expectations	15 – 18
Product Care	19
 SmartDrape™ Shades	
Terminology	20
General Specifications	21
Shade Configurations	22 – 23
Mount Types & Standard Deductions	24 – 25
Parts and Hardware	26
Additional Options	27 – 29
Fabric List & Color Coordination	30 – 31
Fabric Disclaimers & Product Care	32

Size Considerations

	Continuous Cord Loop		Motorized	
	Width	Height	Width	Height
Min	12"	12"	26"	12"
Max	98"	98"	110"	120"
Ratio limit*	The width to height ratio is 1:4 for all fabrics.			

*The height of a continuous cord loop or motorized shade cannot exceed more than 4 times its width.

Side by Side

Side by Side is a great solution for covering wide openings. The shades will have matching vane alignment * and top treatment sizes when the following attributes are the same:

- top treatment type
- mount type
- lift system
 - Motor type* (if applicable)
- color
- shade height
- ordered at the same time

* Vane Alignment

When Side by Side is selected in order entry and the shades are ordered at the same time, with the same color and height, the banded layer alignment will be within a 1/4" tolerance.

Size Definition / Standard Deductions

Shade Width

- Shade with Valance: The shade width is measured from the left edge of the bracket to right edge of bracket
- Shade with Fascia: The shade width is measured from left edge of end cap to right edge of end cap

Shade Height

- The shade height is measured from the top of the raceway to the bottom of the hem bar when the shade is completely lowered

Inside Mount: shade width = order width – 1/8”
Outside Mount: shade width = order width

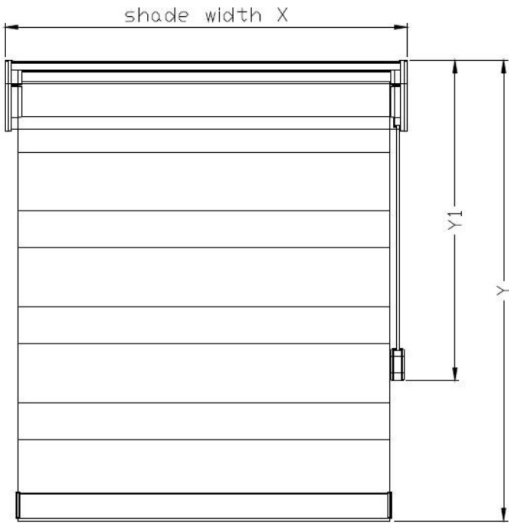

Continuous Cord Loop

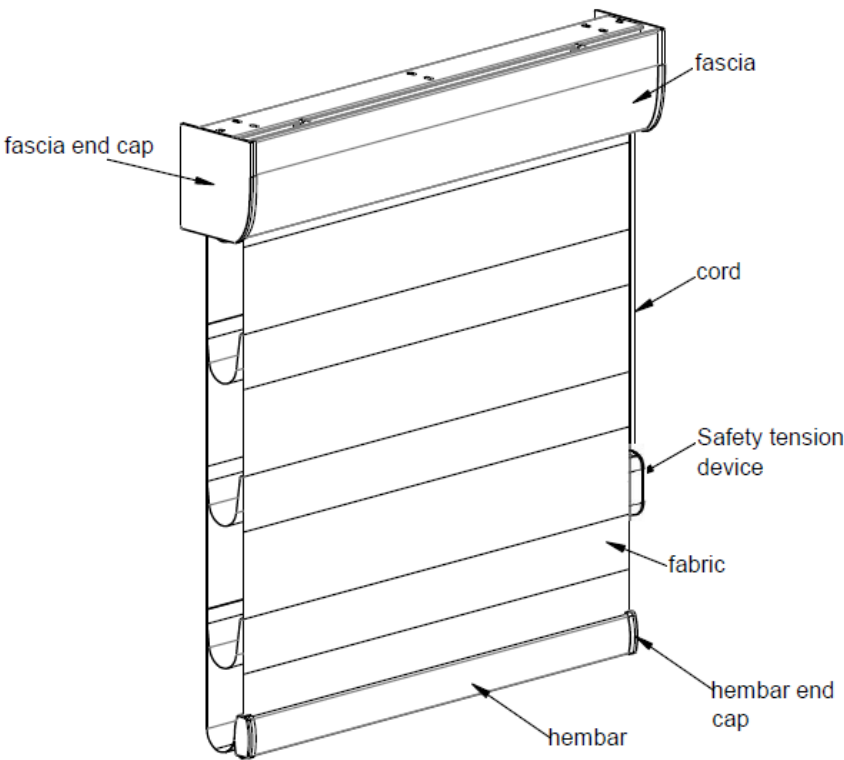

Motorized

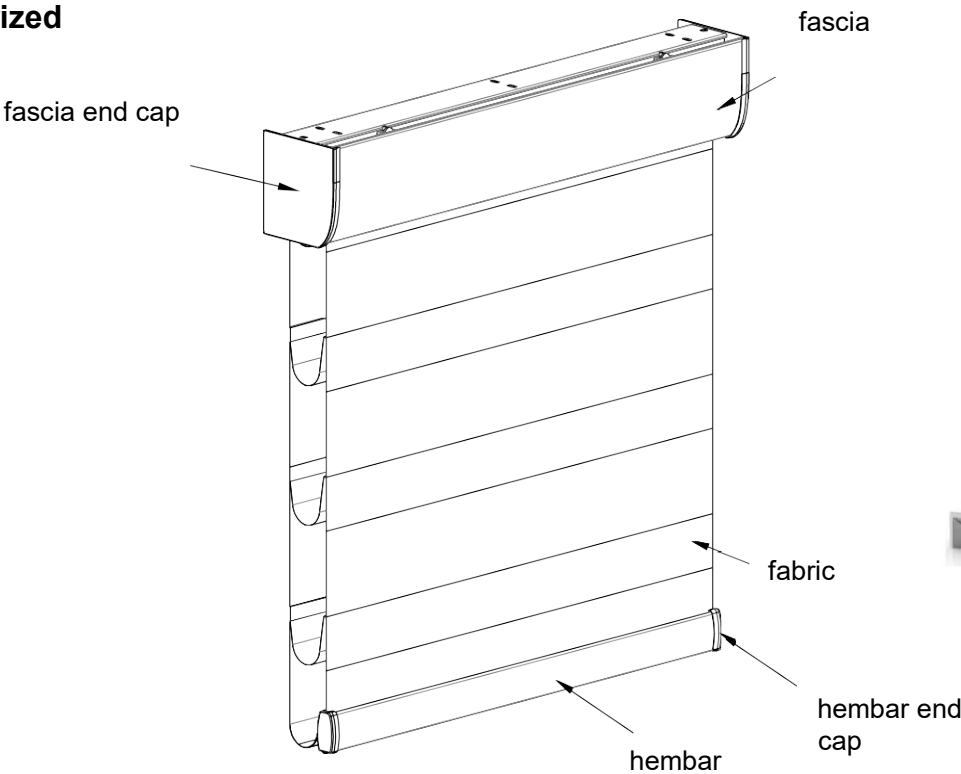

Continuous Cord Loop - Control

Cord Length

	Order Height (Y)	Cord Length
Default	$12'' \leq Y \leq 30''$	16''
	$30'' < Y \leq 42''$	24''
	$42'' < Y \leq 54''$	36''
	$54'' < Y \leq 66''$	48''
	$66'' < Y \leq 90''$	60''
	$90'' < Y \leq 98''$	84''

* Custom length is available with the minimum of 12". No maximum. Cord length is measured from the top of the bracket to the bottom of the safety tension device.



Control Locations

Default	Optional
Right	Left

Top Treatments

- **Standard:** Curved fascia with fabric Insert
 - **Optional:** 4 ½" Fabric Valance
 - **Optional:** Modern Valance
- Additional Options for Top Treatments:
- Common Valance
 - Keystones

**Top Treatments are not recommended for door applications.

Top Treatment Options	Color	Height	Max Width	Remark										
<div></div> <div>Curved Fascia with fabric insert</div>	Same as selected shade fabric	3 1/2" or 4 1/2" *	4 x 95"	<div>*Based on dimensions of shade (4 1/2" size for shade height over 84"). Not optional; except for Side by Side matching purposes.</div> <table><tr><th>Lift System</th><th>Shade Width</th><th>Shade Height</th><th>Curved Fascia Size</th></tr><tr><td rowspan="2">CCL/ Motorized</td><td rowspan="2">All widths</td><td>≤84</td><td>3 1/2"</td></tr><tr><td>>84</td><td>4 1/2"</td></tr></table>	Lift System	Shade Width	Shade Height	Curved Fascia Size	CCL/ Motorized	All widths	≤84	3 1/2"	>84	4 1/2"
Lift System	Shade Width	Shade Height	Curved Fascia Size											
CCL/ Motorized	All widths	≤84	3 1/2"											
		>84	4 1/2"											
<div></div> <div>Fabric Valance</div>	Same as selected shade fabric.	4 1/2"	4 x 95"	Valance returns available for semi IB & OB.										
<div></div> <div>Modern Valance</div>	<div>Paint: 001 Pure White, 003 Silk White, 006 Pearl, 012 Crisp Linen, 049 Stone Gray, 053 Clay</div> <div>Stain: 110 Limed White, 212 Dark Teak, 109 Weathered Teak, 237 Wenge, 221 Black Walnut, 246 Matte Black</div>	4 1/2"	4 x 95"	Material: Wood										

Valance Return Size Options

Valance Type	Semi-Inside Mount	Outside Mount
Fabric	Default: 1" Custom sizes: 1 1/8" ~ 4 ½"	Default: Standard based on shade configurations
Modern Wood	Default: 1" Custom sizes: ½" - 4 ½"	Custom sizes <u>longer</u> than the standard: 1/8" ~ 1"

Customized Top Treatment Width

- The max custom valance width can be up to 12" wider than the shade width.

Common Valance

- Common valance is available in all top treatments
- One common valance can be shared up to 4 independently operated shades.
- The gap between each shade is 0" by default; maximum gap is up to 12".

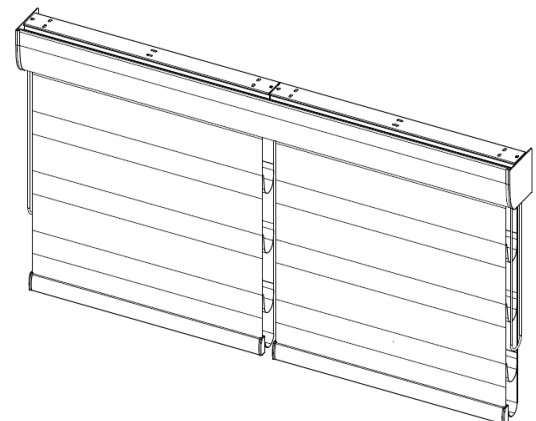

Splicing Top Treatments

Top treatments wider than its maximum limitations will be spliced. A **top treatment joinery** method is required to provide support on all spliced top treatments. This applies to single valances, and all common top treatments.

- Keystones are also available as a decorative touch for all non-spliced top treatments under 95".
- Up to 3 total keystones can be selected per top treatment.

Top Treatment Joinery – Valance Connectors and Keystones

Type	Top Treatment	Max Length	Default Splice Location	Default Valance Joinery	Optional Valance Joinery
Single	Curved Facia	<ul style="list-style-type: none">• Shade Width (X)• Custom: X + 12"	NO SPLICE	N/A—No Splice	Keystones <ul style="list-style-type: none">• Up to 3 qty• Custom split location
Common	Curved Facia	4 x 95"	Centered, widths over 95" (includes end caps)	Keystones	<i>Additional Keystones</i> <ul style="list-style-type: none">• Up to 3 qty• Custom split location• Or at gaps between shades
Single/ Common	Fabric Valance	4 x 95"	Centered, with returns inner widths over 93.75" , without returns inner widths over 95"	Valance Connector	Keystones <ul style="list-style-type: none">• Up to 3 qty• Custom split location• Or at gaps between shades
	Modern Valance				

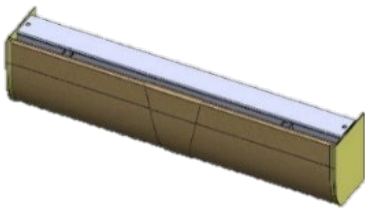

Curved Fascia Keystone

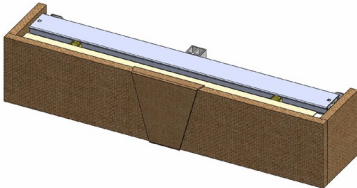

Fabric Valance Keystone

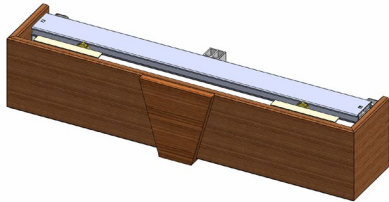

Modern Valance Keystone

Keystone Spacing Requirements

- Measure from the left of the valance inner width to the center of the keystone.

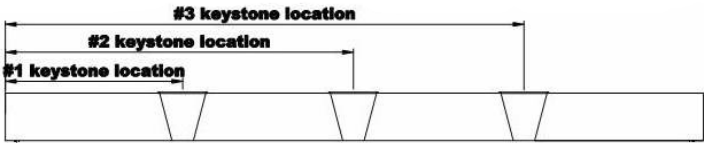

Keystone	Minimum	Maximum	
1st Keystone	18"	Order Width or Custom Valance Length (if applicable)	95"
2nd Keystone	18" + 1st keystone		95" + 1st keystone
3rd Keystone	18" + 2nd keystone		95" + 2nd keystone

IM Mounting Depth - Continuous cord loop

- Small brackets will be supplied for shade heights ≤ 84"
- Large brackets will be supplied for shade heights > 84"
- OM brackets are optional for IM shades when wall/back mount is required.

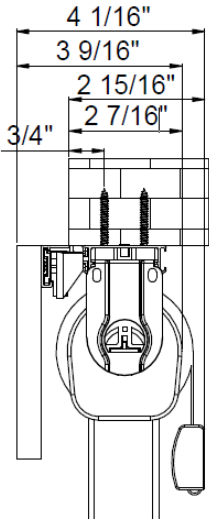
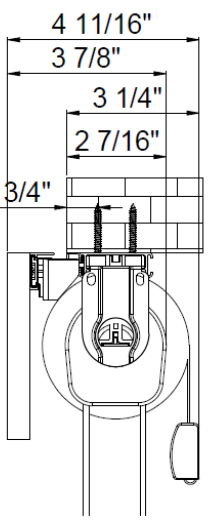
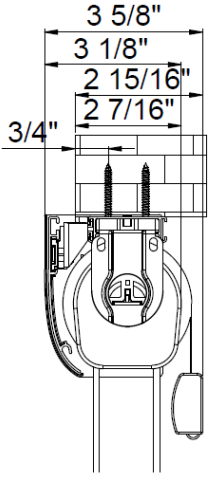
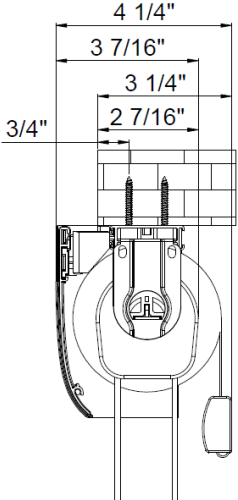
Item	Drawing (with max shade length and RD fabric)	
Cord Loop Shade with Valance	 <p>Small Valance Bracket</p> <p>Dimensions: 4 1/16", 3 9/16", 2 15/16", 2 7/16", 3/4"</p>	 <p>Large Valance Bracket</p> <p>Dimensions: 4 11/16", 3 7/8", 3 1/4", 2 7/16", 3/4"</p>
Cord Loop Shade with Fascia	 <p>Small Valance Bracket</p> <p>Dimensions: 3 5/8", 3 1/8", 2 15/16", 2 7/16", 3/4"</p>	 <p>Large Valance Bracket</p> <p>Dimensions: 4 1/4", 3 7/16", 3 1/4", 2 7/16", 3/4"</p>

IM Mounting Depth - Motorized

- Small brackets will be supplied for shade heights $\leq 84"$
- Large brackets will be supplied for shade heights $> 84"$
- OM brackets are optional for IM shades when wall/back mount is required.

Item	Drawing (with max shade length and RD fabric)	
Motorized Shade with Valance		
	Small Valance Bracket	Large Valance Bracket
Motorized Shade with Fascia		
	Small Valance Bracket	Large Valance Bracket

Inside Mount Fabric Width Deductions

Continuous Cord Loop – Single Inside Mount				
Shade Width	Shade Length	Tube Size	Top Treatment	Finished Fabric Width
12" to 98"	12" to 98"	1 3/4"	CCL with Fascia	Fabric Width = Order Width – 1.64"
			CCL with Valance	Fabric Width = Order Width – 1.44"

Single Motorized - Inside Mount					
Motor Type	Shade Width	Shade Length	Tube Dimensions	Shade Type	Tube/Fabric Width
Norman Smart Rechargeable Battery with AC Adapter Charger	All widths	All heights	1 3/4" / 2"	Motorized with Fascia	Tube Width = Order Width -1.44"
					Fabric Width = Order Width - 1.68"
				Motorized with Valance	Tube Width = Order Width - 1.25"
					Fabric Width = Order Width - 1.48"
All other motorization	All widths	All heights	1 3/4" / 2"	Motorized with Fascia	Tube Width = Order Width - 1.38"
					Fabric Width = Order Width - 1.62"
				Motorized with Valance	Tube Width = Order Width - 1.19"
					Fabric Width = Order Width - 1.42"

OM Mounting Depth

Mounting area required for Outside Mount

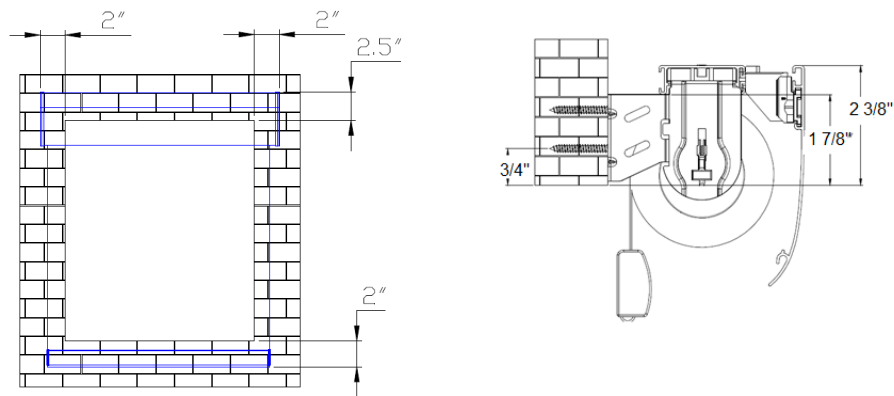

- Light Guard is specifically designed to block incoming light escaping off the top and sides of the window opening.
- Application consists of 2 side blocks (Wood or Aluminum), & a top block

	Dimensions	Available colors
<div>Wood Light Guard (Side)</div>	<div><div><div><div><div><div>7mm (0.28")</div><div>30mm (1.18")</div><div>7mm (0.28")</div></div></div><div><div>7mm (0.28")</div><div>30mm (1.18")</div><div>7mm (0.28")</div></div></div><div><div><div>7mm (0.28")</div><div>35mm (1.38")</div><div>7mm (0.28")</div></div><div><div>7mm (0.28")</div><div>30mm (1.18")</div><div>7mm (0.28")</div></div></div><div><div><div>7mm (0.28")</div><div>35mm (1.38")</div><div>7mm (0.28")</div></div><div><div>7mm (0.28")</div><div>30mm (1.18")</div><div>7mm (0.28")</div></div></div><div><div><div>7mm (0.28")</div><div>30mm (1.18")</div><div>7mm (0.28")</div></div><div><div>7mm (0.28")</div><div>35mm (1.38")</div><div>7mm (0.28")</div></div></div><div><div><div>7mm (0.28")</div><div>30mm (1.18")</div><div>7mm (0.28")</div></div><div><div>7mm (0.28")</div><div>35mm (1.38")</div><div>7mm (0.28")</div></div></div><div><div><div>7mm (0.28")</div><div>30mm (1.18")</div><div>7mm (0.28")</div></div><div><div>7mm (0.28")</div><div>35mm (1.38")</div><div>7mm (0.28")</div></div></div><div><div><div>7mm (0.28")</div><div>30mm (1.18")</div><div>7mm (0.28")</div></div><div><div>7mm (0.28")</div><div>35mm (1.38")</div><div>7mm (0.28")</div></div></div><div><div><div>7mm (0.28")</div><div>30mm (1.18")</div><div>7mm (0.28")</div></div><div><div>7mm (0.28")</div><div>35mm (1.38")</div><div>7mm (0.28")</div></div></div><div><div><div>7mm (0.28")</div><div>30mm (1.18")</div><div>7mm (0.28")</div></div><div><div>7mm (0.28")</div><div>35mm (1.38")</div><div>7mm (0.28")</div></div></div><div><div><div>7mm (0.28")</div><div>30mm (1.18")</div><div>7mm (0.28")</div></div><div><div>7mm (0.28")</div><div>35mm (1.38")</div><div>7mm (0.28")</div></div></div><div><div><div>7mm (0.28")</div><div>30mm (1.18")</div><div>7mm (0.28")</div></div><div><div>7mm (0.28")</div><div>35mm (1.38")</div><div>7mm (0.28")</div></div></div><div><div><div>7mm (0.28")</div><div>30mm (1.18")</div><div>7mm (0.28")</div></div><div><div>7mm (0.28")</div><div>35mm (1.38")</div><div>7mm (0.28")</div></div></div><div><div><div>7mm (0.28")</div><div>30mm (1.18")</div><div>7mm (0.28")</div></div><div><div>7mm (0.28")</div><div>35mm (1.38")</div><div>7mm (0.28")</div></div></div><div><div><div>7mm (0.28")</div><div>30mm (1.18")</div><div>7mm (0.28")</div></div><div><div>7mm (0.28")</div><div>35mm (1.38")</div><div>7mm (0.28")</div></div></div><div><div><div>7mm (0.28")</div><div>30mm (1.18")</div><div>7mm (0.28")</div></div><div><div>7mm (0.28")</div><div>35mm (1.38")</div><div>7mm (0.28")</div></div></div><div><div><div>7mm (0.28")</div><div>30mm (1.18")</div><div>7mm (0.28")</div></div><div><div>7mm (0.28")</div><div>35mm (1.38")</div><div>7mm (0.28")</div></div></div><div><div><div>7mm (0.28")</div><div>30mm (1.18")</div><div>7mm (0.28")</div></div><div><div>7mm (0.28")</div><div>35mm (1.38")</div><div>7mm (0.28")</div></div></div><div><div><div>7mm (0.28")</div><div>30mm (1.18")</div><div>7mm (0.28")</div></div><div><div>7mm (0.28")</div><div>35mm (1.38")</div><div>7mm (0.28")</div></div></div><div><div><div>7mm (0.28")</div><div>30mm (1.18")</div><div>7mm (0.28")</div></div><div><div>7mm (0.28")</div><div>35mm (1.38")</div><div>7mm (0.28")</div></div></div><div><div><div>7mm (0.28")</div><div>30mm (1.18")</div><div>7mm (0.28")</div></div><div><div>7mm (0.28")</div><div>35mm (1.38")</div><div>7mm (0.28")</div></div></div><div><div><div>7mm (0.28")</div><div>30mm (1.18")</div><div>7mm (0.28")</div></div><div><div>7mm (0.28")</div><div>35mm (1.38")</div><div>7mm (0.28")</div></div></div><div><div><div>7mm (0.28")</div><div>30mm (1.18")</div><div>7mm (0.28")</div></div><div><div>7mm (0.28")</div><div>35mm (1.38")</div><div>7mm (0.28")</div></div></div><div><div><div>7mm (0.28")</div><div>30mm (1.18")</div><div>7mm (0.28")</div></div><div><div>7mm (0.28")</div><div>35mm (1.38")</div><div>7mm (0.28")</div></div></div><div><div><div>7mm (0.28")</div><div>30mm (1.18")</div><div>7mm (0.28")</div></div><div><div>7mm (0.28")</div><div>35mm (1.38")</div><div>7mm (0.28")</div></div></div><div><div><div>7mm (0.28")</div><div>30mm (1.18")</div><div>7mm (0.28")</div></div><div><div>7mm (0.28")</div><div>35mm (1.38")</div><div>7mm (0.28")</div></div></div><div><div><div>7mm (0.28")</div><div>30mm (1.18")</div><div>7mm (0.28")</div></div><div><div>7mm (0.28")</div><div>35mm (1.38")</div><div>7mm (0.28")</div></div></div><div><div><div>7mm (0.28")</div><div>30mm (1.18")</div><div>7mm (0.28")</div></div><div><div>7mm (0.28")</div><div>35mm (1.38")</div><div>7mm (0.28")</div></div></div><div><div><div>7mm (0.28")</div><div>30mm (1.18")</div><div>7mm (0.28")</div></div><div><div>7mm (0.28")</div><div>35mm (1.38")</div><div>7mm (0.28")</div></div></div><div><div><div>7mm (0.28")</div><div>30mm (1.18")</div><div>7mm (0.28")</div></div><div><div>7mm (0.28")</div><div>35mm (1.38")</div><div>7mm (0.28")</div></div></div><div><div><div>7mm (0.28")</div><div>30mm (1.18")</div><div>7mm (0.28")</div></div><div><div>7mm (0.28")</div><div>35mm (1.38")</div><div>7mm (0.28")</div></div></div><div><div><div>7mm (0.28")</div><div>30mm (1.18")</div><div>7mm (0.28")</div></div><div><div>7mm (0.28")</div><div>35mm (1.38")</div><div>7mm (0.28")</div></div></div><div><div><div>7mm (0.28")</div><div>30mm (1.18")</div><div>7mm (0.28")</div></div><div><div>7mm (0.28")</div><div>35mm (1.38")</div><div>7mm (0.28")</div></div></div><div><div><div>7mm (0.28")</div><div>30mm (1.18")</div><div>7mm (0.28")</div></div><div><div>7mm (0.28")</div><div>35mm (1.38")</div><div>7mm (0.28")</div></div></div><div><div><div>7mm (0.28")</div><div>30mm (1.18")</div><div>7mm (0.28")</div></div><div><div>7mm (0.28")</div><div>35mm (1.38")</div><div>7mm (0.28")</div></div></div><div><div><div>7mm (0.28")</div><div>30mm (1.18")</div><div>7mm (0.28")</div></div><div><div>7mm (0.28")</div><div>35mm (1.38")</div><div>7mm (0.28")</div></div></div><div><div><div>7mm (0.28")</div><div>30mm (1.18")</div><div>7mm (0.28")</div></div><div><div>7mm (0.28")</div><div>35mm (1.38")</div><div>7mm (0.28")</div></div></div><div><div><div>7mm (0.28")</div><div>30mm (1.18")</div><div>7mm (0.28")</div></div><div><div>7mm (0.28")</div><div>35mm (1.38")</div><div>7mm (0.28")</div></div></div><div><div><div>7mm (0.28")</div><div>30mm (1.18")</div><div>7mm (0.28")</div></div><div><div>7mm (0.28")</div><div>35mm (1.38")</div><div>7mm (0.28")</div></div></div><div><div><div>7mm (0.28")</div><div>30mm (1.18")</div><div>7mm (0.28")</div></div><div><div>7mm (0.28")</div><div>35mm (1.38")</div><div>7mm (0.28")</div></div></div><div><div><div>7mm (0.28")</div><div>30mm (1.18")</div><div>7mm (0.28")</div></div><div><div>7mm (0.28")</div><div>35mm (1.38")</div><div>7mm (0.28")</div></div></div><div><div><div>7mm (0.28")</div><div>30mm (1.18")</div><div>7mm (0.28")</div></div><div><div>7mm (0.28")</div><div>35mm (1.38")</div><div>7mm (0.28")</div></div></div><div><div><div>7mm (0.28")</div><div>30mm (1.18")</div><div>7mm (0.28")</div></div><div><div>7mm (0.28")</div><div>35mm (1.38")</div><div>7mm (0.28")</div></div></div><div><div><div>7mm (0.28")</div><div>30mm (1.18")</div><div>7mm (0.28")</div></div><div><div>7mm (0.28")</div><div>35mm (1.38")</div><div>7mm (0.28")</div></div></div><div><div><div>7mm (0.28")</div><div>30mm (1.18")</div><div>7mm (0.28")</div></div><div><div>7mm (0.28")</div><div>35mm (1.38")</div><div>7mm (0.28")</div></div></div><div><div><div>7mm (0.28")</div><div>30mm (1.18")</div><div>7mm (0.28")</div></div><div><div>7mm (0.28")</div><div>35mm (1.38")</div><div>7mm (0.28")</div></div></div><div><div><div>7mm (0.28")</div><div>30mm (1.18")</div><div>7mm (0.28")</div></div><div><div>7mm (0.28")</div><div>35mm (1.38")</div><div>7mm (0.28")</div></div></div><div><div><div>7mm (0.28")</div><div>30mm (1.18")</div><div>7mm (0.28")</div></div><div><div>7mm (0.28")</div><div>35mm (1.38")</div><div>7mm (0.28")</div></div></div><div><div><div>7mm (0.28")</div><div>30mm (1.18")</div><div>7mm (0.28")</div></div><div><div>7mm (0.28")</div><div>35mm (1.38")</div><div>7mm (0.28")</div></div></div><div><div><div>7mm (0.28")</div><div>30mm (1.18")</div><div>7mm (0.28")</div></div><div><div>7mm (0.28")</div><div>35mm (1.38")</div><div>7mm (0.28")</div></div></div><div><div><div>7mm (0.28")</div><div>30mm (1.18")</div><div>7mm (0.28")</div></div><div><div>7mm (0.28")</div><div>35mm (1.38")</div><div>7mm (0.28")</div></div></div><div><div><div>7mm (0.28")</div><div>30mm (1.18")</div><div>7mm (0.28")</div></div><div><div>7mm (0.28")</div><div>35mm (1.38")</div><div>7mm (0.28")</div></div></div><div><div><div>7mm (0.28")</div><div>30mm (1.18")</div><div>7mm (0.28")</div></div><div><div>7mm (0.28")</div><div>35mm (1.38")</div><div>7mm (0.28")</div></div></div><div><div><div>7mm (0.28")</div><div>30mm (1.18")</div><div>7mm (0.28")</div></div><div><div>7mm (0.28")</div><div>35mm (1.38")</div><div>7mm (0.28")</div></div></div><div><div><div>7mm (0.28")</div><div>30mm (1.18")</div><div>7mm (0.28")</div></div><div><div>7mm (0.28")</div><div>35mm (1.38")</div><div>7mm (0.28")</div></div></div><div><div><div>7mm (0.28")</div><div>30mm (1.18")</div><div>7mm (0.28")</div></div><div><div>7mm (0.28")</div><div>35mm (1.38")</div><div>7mm (0.28")</div></div></div><div><div><div>7mm (0.28")</div><div>30mm (1.18")</div><div>7mm (0.28")</div></div><div><div>7mm (0.28")</div><div>35mm (1.38")</div><div>7mm (0.28")</div></div></div><div><div><div>7mm (0.28")</div><div>30mm (1.18")</div><div>7mm (0.28")</div></div><div><div>7mm (0.28")</div><div>35mm (1.38")</div><div>7mm (0.28")</div></div></div><div><div><div>7mm (0.28")</div><div>30mm (1.18")</div><div>7mm (0.28")</div></div><div><div>7mm (0.28")</div><div>35mm (1.38")</div><div>7mm (0.28")</div></div></div><div><div><div>7mm (0.28")</div><div>30mm (1.18")</div><div>7mm (0.28")</div></div><div><div>7mm (0.28")</div><div>35mm (1.38")</div><div>7mm (0.28")</div></div></div><div><div><div>7mm (0.28")</div><div>30mm (1.18")</div><div>7mm (0.28")</div></div><div><div>7mm (0.28")</div><div>35mm (1.38")</div><div>7mm (0.28")</div></div></div><div><div><div>7mm (0.28")</div><div>30mm (1.18")</div><div>7mm (0.28")</div></div><div><div>7mm (0.28")</div><div>35mm (1.38")</div><div>7mm (0.28")</div></div></div><div><div><div>7mm (0.28")</div><div>30mm (1.18")</div><div>7mm (0.28")</div></div><div><div>7mm (0.28")</div><div>35mm (1.38")</div><div>7mm (0.28")</div></div></div><div><div><div>7mm (0.28")</div><div>30mm (1.18")</div><div>7mm (0.28")</div></div><div><div>7mm (0.28")</div><div>35mm (1.38")</div><div>7mm (0.28")</div></div></div><div><div><div>7mm (0.28")</div><div>30mm (1.18")</div><div>7mm (0.28")</div></div><div><div>7mm (0.28")</div><div>35mm (1.38")</div><div>7mm (0.28")</div></div></div><div><div><div>7mm (0.28")</div><div>30mm (1.18")</div><div>7mm (0.28")</div></div><div><div>7mm (0.28")</div><div>35mm (1.38")</div><div>7mm (0.28")</div></div></div><div><div><div>7mm (0.28")</div><div>30mm (1.18")</div><div>7mm (0.28")</div></div><div><div>7mm (0.28")</div><div>35mm (1.38")</div><div>7mm (0.28")</div></div></div><div><div><div>7mm (0.28")</div><div>30mm (1.18")</div><div>7mm (0.28")</div></div><div><div>7mm (0.28")</div><div>35mm (1.38")</div><div>7mm (0.28")</div></div></div><div><div><div>7mm (0.28")</div><div>30mm (1.18")</div><div>7mm (0.28")</div></div><div><div>7mm (0.28")</div><div>35mm (1.38")</div><div>7mm (0.28")</div></div></div><div><div><div>7mm (0.28")</div><div>30mm (1.18")</div><div>7mm (0.28")</div></div><div><div>7mm (0.28")</div><div>35mm (1.38")</div><div>7mm (0.28")</div></div></div><div><div><div>7mm (0.28")</div><div>30mm (1.18")</div><div>7mm (0.28")</div></div><div><div>7mm (0.28")</div><div>35mm (1.38")</div><div>7mm (0.28")</div></div></div><div><div><div>7mm (0.28")</div><div>30mm (1.18")</div><div>7mm (0.28")</div></div><div><div>7mm (0.28")</div><div>35mm (1.38")</div><div>7mm (0.28")</div></div></div><div><div><div>7mm (0.28")</div><div>30mm (1.18")</div><div>7mm (0.28")</div></div><div><div>7mm (0.28")</div><div>35mm (1.38")</div><div>7mm (0.28")</div></div></div><div><div><div>7mm (0.28")</div><div>30mm (1.18")</div><div>7mm (0.28")</div></div><div><div>7mm (0.28")</div><div>35mm (1.38")</div><div>7mm (0.28")</div></div></div><div><div><div>7mm (0.28")</div><div>30mm (1.18")</div><div>7mm (0.28")</div></div><div><div>7mm (0.28")</div><div>35mm (1.38")</div><div>7mm (0.28")</div></div></div><div><div><div>7mm (0.28")</div><div>30mm (1.18")</div><div>7mm (0.28")</div></div><div><div>7mm (0.28")</div><div>35mm (1.38")</div><div>7mm (0.28")</div></div></div><div><div><div>7mm (0.28")</div><div>30mm (1.18")</div><div>7mm (0.28")</div></div><div><div>7mm (0.28")</div><div>35mm (1.38")</div><div>7mm (0.28")</div></div></div><div><div><div>7mm (0.28")</div><div>30mm (1.18")</div><div>7mm (0.28")</div></div><div><div>7mm (0.28")</div><div>35mm (1.38")</div><div>7mm (0.28")</div></div></div><div><div><div>7mm (0.28")</div><div>30mm (1.18")</div><div>7mm (0.28")</div></div><div><div>7mm (0.28")</div><div>35mm (1.38")</div><div>7mm (0.28")</div></div></div><div><div><div>7mm (0.28")</div><div>30mm (1.18")</div><div>7mm (0.28")</div></div><div><div>7mm (0.28")</div><div>35mm (1.38")</div><div>7mm (0.28")</div></div></div><div><div><div>7mm (0.28")</div><div>30mm (1.18")</div><div>7mm (0.28")</div></div><div><div>7mm (0.28")</div><div>35mm (1.38")</div><div>7mm (0.28")</div></div></div><div><div><div>7mm (0.28")</div><div>30mm (1.18")</div><div>7mm (0.28")</div></div><div><div>7mm (0.28")</div><div>35mm</div></div></div></div></div>	

- Dimensions: 1 5/8" x 3/8"
- Aprox. 3/8" thick for one and 11/16" thick for two stacked
- Up to 3 shims/spacers can be stacked per bracket

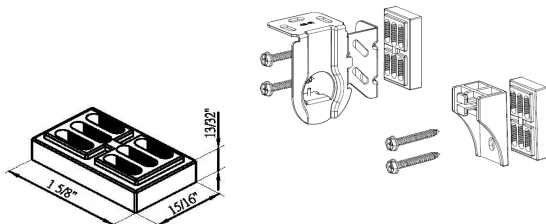

Shade width X	8"≤X≤40"	40"<X≤80"	X>80"
# of mounting brackets	2	3	4
# of shims (1 layer)	2	3	4
# of shims (2 layers)	4	6	8
# of shims (3 layer)	6	9	12

Magnetic Hold-Down

- Two hold down brackets (one for the left and the right side of the shade) will be provided for each shade when requested.
- Defaulted for door applications.
 - Magnetic hold-downs are required for door applications to help keep the shade in place.
 - Not recommended for metal door applications.
- Optional for window applications.
- The magnet will be pre-installed at the factory on the hem bar.
- The magnet catch, which needs to be installed at the job site, can be found in the hardware box.

Allow extra wall space for installation:

- 9/16" in length from the side edge of the shade
- 11/16" in height from the bottom edge of the shade

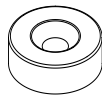

Magnet

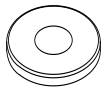

Magnet Catch

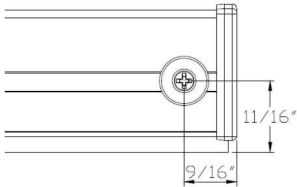
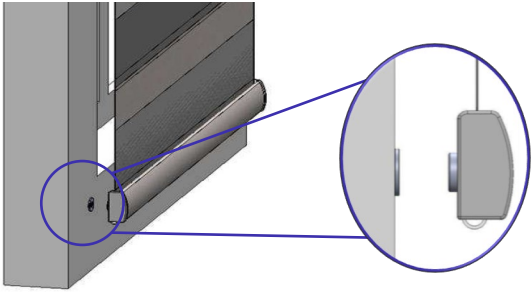

Available colors for Magnet Catch

- Nickel-Plated (Default)
- (Optional) Pure White, Silk White, Bisque, Pearl, Bright Brass, Antique Brass, Black, Crisp Linen, String, Sea Mist, Stone Gray, Brown Gray, Taupe Gray

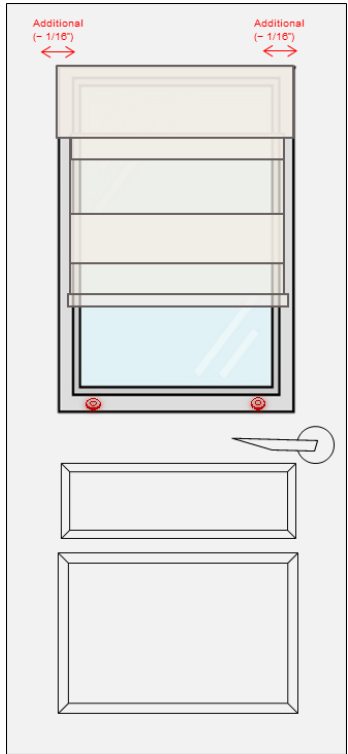

PerfectSheer Shades Installed on a Door

To receive shades suited for door applications, please select the option during order entry. When selected,

- Shades will have an additional fabric deduction of approximately 1/16" (2mm) on each side in order to prevent the fabric from fraying. (See fabric deductions by lift system for total fabric width deductions.)
- Magnetic hold-downs are defaulted and required when installed on a door.
- Top Treatments are available but not recommended for door applications.

	Fabric List				Color Coordination (For CCL only)		
	Opacity	Fabric Code	Color Code	Color Name	Cord Color	Raceway, Brackets, Hem bar	Fascia/Hembar end caps, Safety tension device, Clutch
1	Light Filtering	AA0330	F1191	Nightfall	Dark Gray	Black	Black
2			F1192	Granite	Dark Gray	Black	Black
3			F1193	Mineral	Silver	Ivory	Chocolate
4		AA0326	F1178	Snowflake	White	White	White
5			F1179	Lily Cream	Alabaster	Ivory	Ivory
6			F1180	Dunes	Petal Pink	Ivory	Terra
7			F1181	Smoke	Smoke	White	Silver
8			F1182	Midnight	Black	Black	Black
9		AA0327	F1183	Cottonwood	Petal Pink	Ivory	Nature
10			F1184	Cedar Cream	Alabaster	Ivory	Sahara
11			F1185	Quarry	Silver	White	Silver
12		AA0328	F1186	Soft White	White	White	White
13			F1187	Cinnamon	Petal Pink	White	Terra
14		AA0329	F1188	Platinum	Silver	Ivory	Ivory
15			F1189	Magnetic Gray	Smoke	White	Silver
16			F1190	Cast Iron	Dark Gray	Black	Black
17		AA0331	F1194	Frosty Asphalt	Dark Gray	Black	Black
18			F1195	Frosty Gray	Silver	White	Silver
19			F1196	Frosty White	White	White	White
20		AA0332	F1197	Light Gray	Smoke	White	Silver
21		AA0335	F1363	Ivory	Alabaster	Ivory	Ivory
22			F1364	Silver	White	White	White
23	Room Darkening	AB0642	F1200	Moon	White	White	White
24			F1201	Silk	Alabaster	Ivory	Ivory
25			F1202	Chai Latte	Petal Pink	Ivory	Terra
26			F1203	Sky	Smoke	White	Silver
27			F1204	Mars Black	Black	Black	Black
28		AB0643	F1205	Seaside	Petal Pink	Ivory	Nature
29			F1206	Palm	Alabaster	Ivory	Sahara
30			F1207	Stone	Silver	White	Silver
31		AB0644	F1208	Heather Gray	Smoke	White	Silver
32		AB0645	F1209	Ash Gray	Dark Gray	Black	Black

Fabric Composition: 100% Polyester

Sheer Shades have been an elegant window treatment solution for decades. Our introduction of PerfectSheer™ comes after years of engineering and design. PerfectSheer™ truly delivers on a number of desired effects of fine window treatments:

- Light transformation
- UV protection
- Softened views while enjoying privacy



We have delivered on these needs while incorporating superior industry enhancements:

- Tightest vane closure in its category for privacy/light control
- 100% Woven seams; not glued, sewn or heat fused
- Hem bar doesn't rise above the window sill in the closed position

But as with all fine window treatments there are certain inherent characteristics of a PerfectSheer™ Shade that can be found in any sheer shade in the market. Since we always strive to provide the highest quality window treatment solutions, we are communicating certain industry-wide operation or fabric characteristics of sheer shades.

Room Darkening versus Blackout Quality

One of the appealing characteristics of a sheer shade is its ability to softly filter light when open and provide varying levels of privacy when closed. While our room darkening fabrics provide more privacy and light control qualities than our light filtering choices, they are not a total blackout solution.

This results from several operating aspects associated with any sheer shade:

Multi Plane Operation

Because of the need to operate on several opposing planes – height, width, depth and in between angles, PerfectSheer™'s vanes are not designed to close completely, most notably at the bottom of the shade. However, vane overlap ensures that privacy is not compromised.



Front View



Side View

Hem Bar Rotation

An inherent characteristic of a sheer shade is that the bottom hem bar rises and lowers off the window sill as the vanes are rotated. Fortunately, unlike some other sheer shades, PerfectSheer™ is designed where the hem bar rests on the window sill when the vanes are closed and rises slightly in the open position, providing maximum light control and privacy.



Open Position



Closed Position

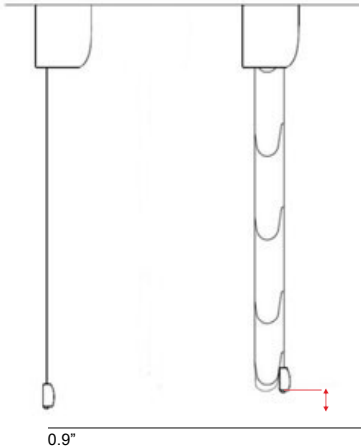

Fabric Characteristics

PerfectSheer™ offers an array of light filtering and room darkening fabrics. As is the nature of all textiles, there are certain characteristics associated with our fabric collection that are considered normal and not flaws.

Wrinkles, Creases and Reverse Light Effect

Slight wrinkles, creases and reverse light effects may appear which are considered normal

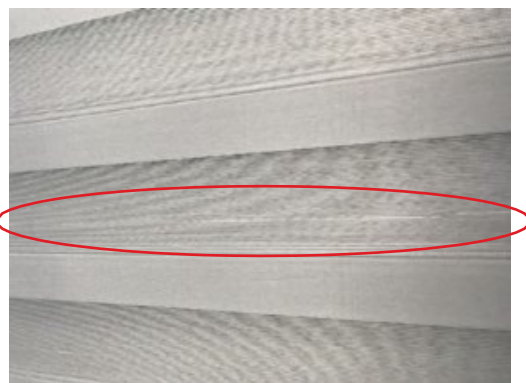

Woven Seam Construction

Because PerfectSheer™'s seams are finely woven not glued, sewn or heat fused, they have a more natural appearance and may not be perfectly straight



Edge Fraying

Small strands of sheer yarn may appear on the shade's vertical edges because of the nature of sheer fabrics. These are considered normal and may be clipped by the consumer. The weaving process may also result in edges that are not perfectly aligned.

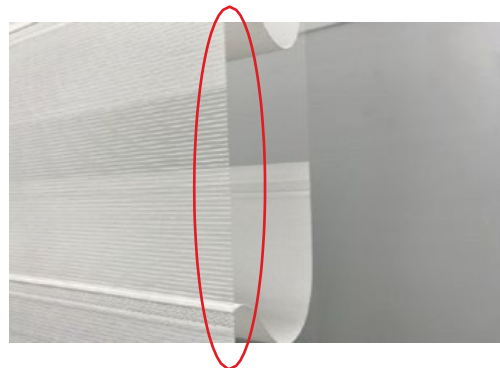

Vane Bowing

The top vane of the shade may bow slightly which is considered normal

**Order Accuracy****Vane Alignment**

When Side by Side is selected in order entry and the shades ordered at the same time, with the same color and height, the banded layer alignment will be within a 1/4" tolerance.

**This includes RGAs. As long as all other criteria is identical, the RGA shades will be subject to the same vane alignment rule with 1/4" tolerance.*

Shade Height

When confirming the accuracy of the ordered height measure with the vanes fully closed.

Our Heritage of Quality

With Norman®, Quality isn't just a catchphrase, it's our Heritage.

Our PerfectSheer™ shade will provide your consumer with years of trouble-free operation and enjoyment. It is of course backed by our Lifetime Warranty should anything out of the ordinary occur

Maintaining PerfectSheer™ Shades

Routine cleaning will help maintain the beauty of your shade. Here are the proper methods for cleaning PerfectSheer shades:

Light Dusting

- Use a duster or gentle air blower to remove any dust. Do not vacuum.

Spot Cleaning

- Spot cleaning is not recommended as the fabric material is not water resistant.
- If necessary, use a soft cloth or non-abrasive sponge with lukewarm water and blot the shade gently to avoid creasing or damaging the fabric. Rubbing may damage the fabric.
 - After spot-cleaning, keep the shade lowered and do not lift until fabric has completely dried.
 - Do not use bleach or cleaning products that contain bleach.

Ironing

- One of the benefits of polyester is its non-wrinkling qualities. However, if wrinkles or creases develop, use a steam iron on a medium heat setting (356°F-392°F) to eliminate any unwanted wrinkles.



SmartDrape™

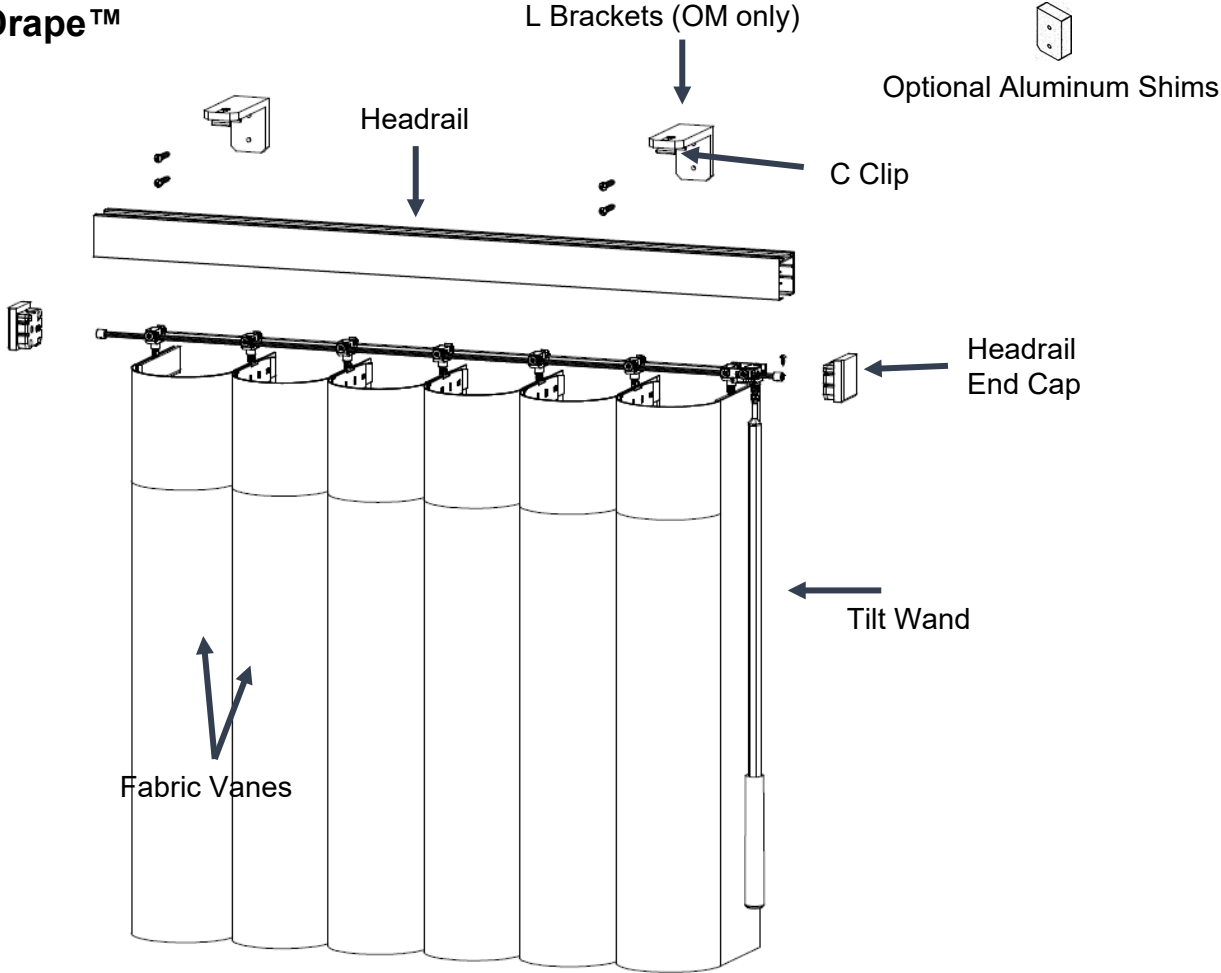

SmartDrape™ with SmartJoint™

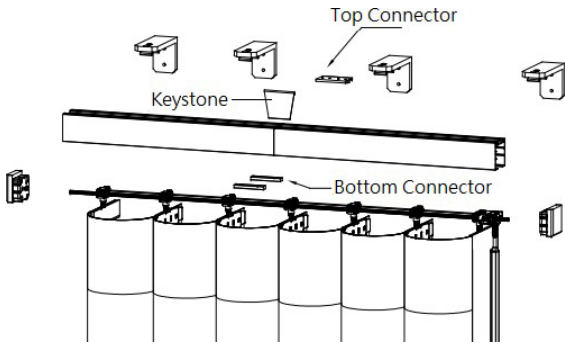

Spliced once with SmartJoint™
Single 97 5/8" ~ 189 5/8"
Side by Side 95 7/8" ~ 188 1/8"

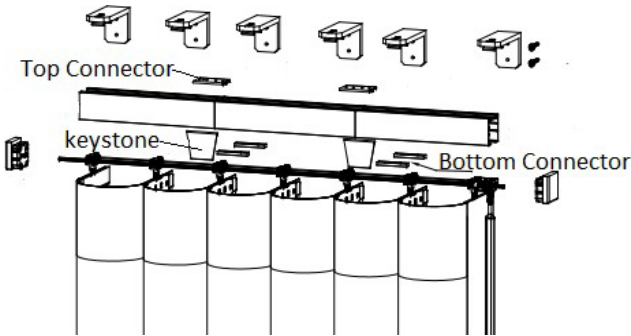

Spliced twice with SmartJoint™
Single 193 5/8" ~ 285 5/8"
Side by Side 192 1/8" ~ 284 3/8"

Stack Options

Single Shade

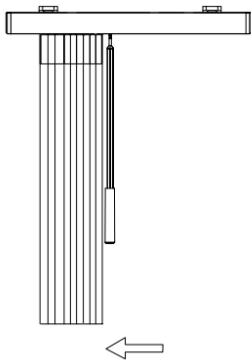

Stack Left

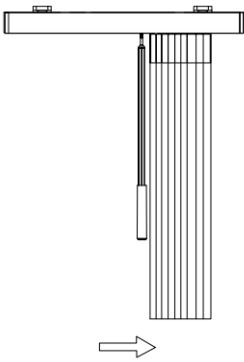

Stack Right

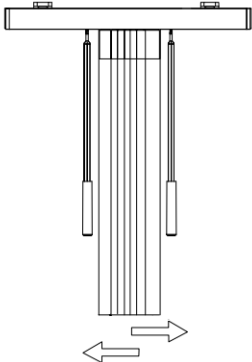

Traveling Center Stack
(Includes wands on each side)

Side by Side Shades

Two independently operated shades butt together

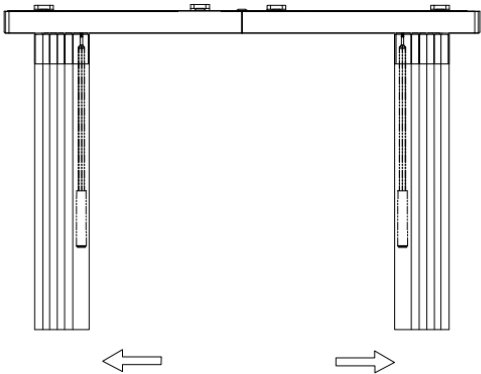

Left Shade Stacks Left,
Right Shade Stacks Right

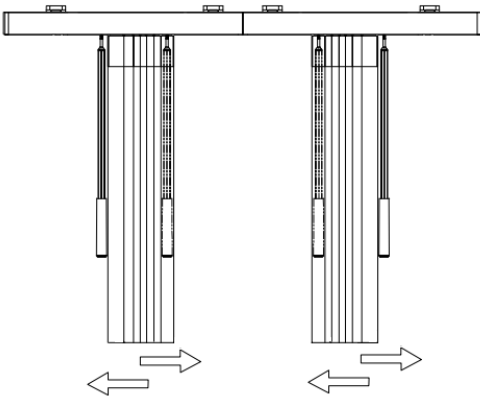

Both Shades: Traveling Center Stack
(Includes wands on each side for
both shades)

Size Limitations

Single			Side by Side Combine Two Shades		
	Track Width (Shade Width)	Height		Track Width (Shade Width)	Height
Min	17 5/8" (12 1/8")	24"	Min	15 5/8" (12 1/8")	24"
Max	285 5/8" (280 1/8")	120"	Max	284 3/8" (280 1/8")	120"

Shade Configurations – Single Shade

- There are 68 widths available for a single stack; each at a 4" increment (see track list on next page)
 - Single Tracks not available to combine as two Side by Side shades.
 - Tracks 97 5/8" through 189 5/8" will be spliced once at the center by SmartJoint™; keystone optional.
 - Tracks 193 5/8" through 285 5/8" will be spliced twice, evenly, by SmartJoint™; keystones optional.
- The stacking widths are estimated measurements with a tolerance:
 - +/- 13/16" variance for single shades with one standard wand (Left Stack or Right Stack)
 - +/- 1 7/8" variance for single shades with an additional wand option

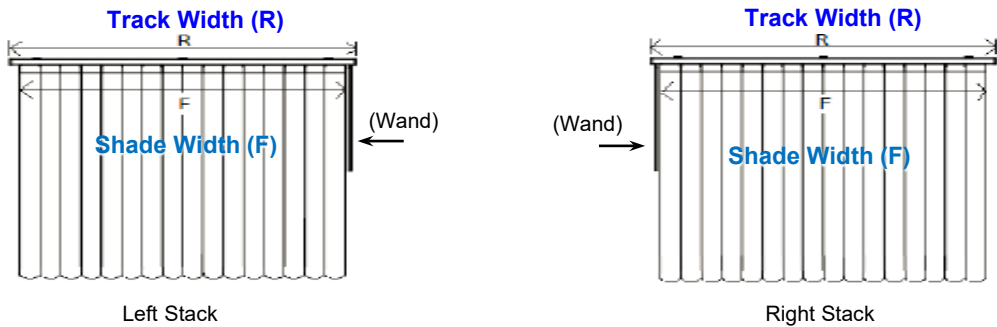

Shade Configurations – Side by Side

Side by Side: two individually operated shades joined together, suitable for very large windows. To minimize the center gap between shades, the wands will be attached behind the fabric vanes on Side by Side shades.

- There are 68 widths available to combine as Side by Side shades (see track list on next page)
 - Side by Side tracks not available as a single shade.
 - Tracks 95 7/8" through 188 1/8" will be spliced once at the center by SmartJoint™; keystone optional.
 - Tracks 192 1/8" through 284 3/8" will be spliced twice, evenly, by SmartJoint™; keystones optional.
 - Keystones are also available for the center joinery for the two headrails.
- The stacking widths are estimated measurements with a tolerance:
 - +/- 13/16" variance for each shade with one standard wand (Left Stack or Right Stack)
 - +/- 1 7/8" variance for each shade with an additional wand option

Center Gaps

- Side by Side shades will still include gaps at the center where the 2 headrails are combined. See the center gaps below based on the combined track sizes.
- When the vanes are open, the gap size between shades will be based on the two track sizes ordered.
- There is no gap when fabric vanes are closed.

First Track Width (R)	Second Track Width (R)	Gap (± 1/8")
$X1 \leq 78"$	$X1 \leq 78"$	1 1/2"
$X1 \leq 78"$	$78" < X1 \leq 144"$	1 3/4"
$78" < X1 \leq 144"$	$78" < X1 \leq 144"$	2"
$144" < X1 \leq 216"$	$78" < X1 \leq 144"$	2 1/4"
$144" < X1 \leq 216"$	$144" < X1 \leq 216"$	2 1/2"
$216" < X1 \leq 285 \frac{5}{8}"$	$144" < X1 \leq 216"$	2 3/4"
$216" < X1 \leq 285 \frac{5}{8}"$	$216" < X1 \leq 285 \frac{5}{8}"$	3"

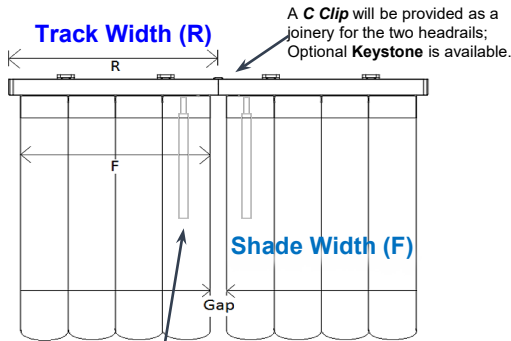

Wands at the center will be behind fabric vanes to minimize gaps.

Shade Configurations

Single				
	Track Width (R)	Shade Width (F)	Vane Qty	Stacking Width**
1	17 5/8"	12 1/8"	3	5 7/16"
2	21 5/8"	16 1/8"	4	6"
3	25 5/8"	20 1/8"	5	6 5/8"
4	29 5/8"	24 1/8"	6	7 3/16"
5	33 5/8"	28 1/8"	7	7 13/16"
6	37 5/8"	32 1/8"	8	8 3/8"
7	41 5/8"	36 1/8"	9	9"
8	45 5/8"	40 1/8"	10	9 9/16"
9	49 5/8"	44 1/8"	11	10 3/16"
10	53 5/8"	48 1/8"	12	10 3/4"
11	57 5/8"	52 1/8"	13	11 5/16"
12	61 5/8"	56 1/8"	14	11 3/4"
13	65 5/8"	60 1/8"	15	12 1/4"
14	69 5/8"	64 1/8"	16	12 11/16"
15	73 5/8"	68 1/8"	17	13 1/8"
16	77 5/8"	72 1/8"	18	13 9/16"
17	81 5/8"	76 1/8"	19	14"
18	85 5/8"	80 1/8"	20	14 7/16"
19	89 5/8"	84 1/8"	21	14 7/8"
20	93 5/8"	88 1/8"	22	15 5/16"
21	97 5/8"	92 1/8"	23	15 3/4"
22	101 5/8"	96 1/8"	24	16 3/16"
23	105 5/8"	100 1/8"	25	16 5/8"
24	109 5/8"	104 1/8"	26	17 1/16"
25	113 5/8"	108 1/8"	27	17 1/2"
26	117 5/8"	112 1/8"	28	17 15/16"
27	121 5/8"	116 1/8"	29	18 3/8"
28	125 5/8"	120 1/8"	30	18 13/16"
29	129 5/8"	124 1/8"	31	19 1/4"
30	133 5/8"	128 1/8"	32	19 11/16"
31	137 5/8"	132 1/8"	33	20 3/16"
32	141 5/8"	136 1/8"	34	20 5/8"
33	145 5/8"	140 1/8"	35	21 1/16"
34	149 5/8"	144 1/8"	36	21 1/2"
35	153 5/8"	148 1/8"	37	21 15/16"
36	157 5/8"	152 1/8"	38	22 3/8"
37	161 5/8"	156 1/8"	39	22 13/16"
38	165 5/8"	160 1/8"	40	23 1/4"
39	169 5/8"	164 1/8"	41	23 11/16"
40	173 5/8"	168 1/8"	42	24 1/8"
41	177 5/8"	172 1/8"	43	24 9/16"
42	181 5/8"	176 1/8"	44	25"
43	185 5/8"	180 1/8"	45	25 7/16"
44	189 5/8"	184 1/8"	46	25 7/8"
45	193 5/8"	188 1/8"	47	26 5/16"
46	197 5/8"	192 1/8"	48	26 3/4"
47	201 5/8"	196 1/8"	49	27 3/16"
48	205 5/8"	200 1/8"	50	27 5/8"
49	209 5/8"	204 1/8"	51	28 1/8"
50	213 5/8"	208 1/8"	52	28 9/16"
51	217 5/8"	212 1/8"	53	29"
52	221 5/8"	216 1/8"	54	29 7/16"
53	225 5/8"	220 1/8"	55	29 7/8"
54	229 5/8"	224 1/8"	56	30 5/16"
55	233 5/8"	228 1/8"	57	30 3/4"
56	237 5/8"	232 1/8"	58	31 3/16"
57	241 5/8"	236 1/8"	59	31 5/8"
58	245 5/8"	240 1/8"	60	32 1/16"
59	249 5/8"	244 1/8"	61	32 1/2"
60	253 5/8"	248 1/8"	62	32 15/16"
61	257 5/8"	252 1/8"	63	33 3/8"
62	261 5/8"	256 1/8"	64	33 13/16"
63	265 5/8"	260 1/8"	65	34 1/4"
64	269 5/8"	264 1/8"	66	34 11/16"
65	273 5/8"	268 1/8"	67	35 1/8"
66	277 5/8"	272 1/8"	68	35 9/16"
67	281 5/8"	276 1/8"	69	36 1/16"
68	285 5/8"	280 1/8"	70	36 1/2"

Side by Side				
	Track Width (R)	Shade Width (F)	Vane Qty	Stacking Width**
1	15 5/8"	12 1/8"	3	6 1/2"
2	19 5/8"	16 1/8"	4	7 1/8"
3	23 5/8"	20 1/8"	5	7 11/16"
4	27 5/8"	24 1/8"	6	8 1/4"
5	31 5/8"	28 1/8"	7	8 7/8"
6	35 5/8"	32 1/8"	8	9 7/16"
7	39 5/8"	36 1/8"	9	10 1/16"
8	43 5/8"	40 1/8"	10	10 5/8"
9	47 5/8"	44 1/8"	11	11 1/4"
10	51 5/8"	48 1/8"	12	11 13/16"
11	55 5/8"	52 1/8"	13	12 7/16"
12	59 5/8"	56 1/8"	14	12 7/8"
13	63 5/8"	60 1/8"	15	13 5/16"
14	67 5/8"	64 1/8"	16	13 3/4"
15	71 5/8"	68 1/8"	17	14 3/16"
16	75 5/8"	72 1/8"	18	14 5/8"
17	79 7/8"	76 1/8"	19	15 1/16"
18	83 7/8"	80 1/8"	20	15 1/2"
19	87 7/8"	84 1/8"	21	15 15/16"
20	91 7/8"	88 1/8"	22	16 3/8"
21	95 7/8"	92 1/8"	23	16 13/16"
22	99 7/8"	96 1/8"	24	17 1/4"
23	103 7/8"	100 1/8"	25	17 11/16"
24	107 7/8"	104 1/8"	26	18 1/8"
25	111 7/8"	108 1/8"	27	18 9/16"
26	115 7/8"	112 1/8"	28	19"
27	119 7/8"	116 1/8"	29	19 7/16"
28	123 7/8"	120 1/8"	30	19 7/8"
29	127 7/8"	124 1/8"	31	20 3/8"
30	131 7/8"	128 1/8"	32	20 13/16"
31	135 7/8"	132 1/8"	33	21 1/4"
32	139 7/8"	136 1/8"	34	21 11/16"
33	144 1/8"	140 1/8"	35	22 1/8"
34	148 1/8"	144 1/8"	36	22 9/16"
35	152 1/8"	148 1/8"	37	23"
36	156 1/8"	152 1/8"	38	23 7/16"
37	160 1/8"	156 1/8"	39	23 7/8"
38	164 1/8"	160 1/8"	40	24 5/16"
39	168 1/8"	164 1/8"	41	24 3/4"
40	172 1/8"	168 1/8"	42	25 3/16"
41	176 1/8"	172 1/8"	43	25 5/8"
42	180 1/8"	176 1/8"	44	26 1/16"
43	184 1/8"	180 1/8"	45	26 1/2"
44	188 1/8"	184 1/8"	46	26 15/16"
45	192 1/8"	188 1/8"	47	27 3/8"
46	196 1/8"	192 1/8"	48	27 13/16"
47	200 1/8"	196 1/8"	49	28 5/16"
48	204 1/8"	200 1/8"	50	28 3/4"
49	208 1/4"	204 1/8"	51	29 3/16"
50	212 1/4"	208 1/8"	52	29 5/8"
51	216 1/4"	212 1/8"	53	30 1/16"
52	220 3/8"	216 1/8"	54	30 1/2"
53	224 3/8"	220 1/8"	55	30 15/16"
54	228 3/8"	224 1/8"	56	31 3/8"
55	232 3/8"	228 1/8"	57	31 13/16"
56	236 3/8"	232 1/8"	58	32 1/4"
57	240 3/8"	236 1/8"	59	32 11/16"
58	244 3/8"	240 1/8"	60	33 1/8"
59	248 3/8"	244 1/8"	61	33 9/16"
60	252 3/8"	248 1/8"	62	34"
61	256 3/8"	252 1/8"	63	34 7/16"
62	260 3/8"	256 1/8"	64	34 7/8"
63	264 3/8"	260 1/8"	65	35 5/16"
64	268 3/8"	264 1/8"	66	35 3/4"
65	272 3/8"	268 1/8"	67	36 1/4"
66	276 3/8"	272 1/8"	68	36 11/16"
67	280 3/8"	276 1/8"	69	37 1/8"
68	284 3/8"	280 1/8"	70	37 9/16"

Mount Types and Standard Deductions

Mounting Types

- Outside mount only
 - Window, patio door wall mount or ceiling pocket

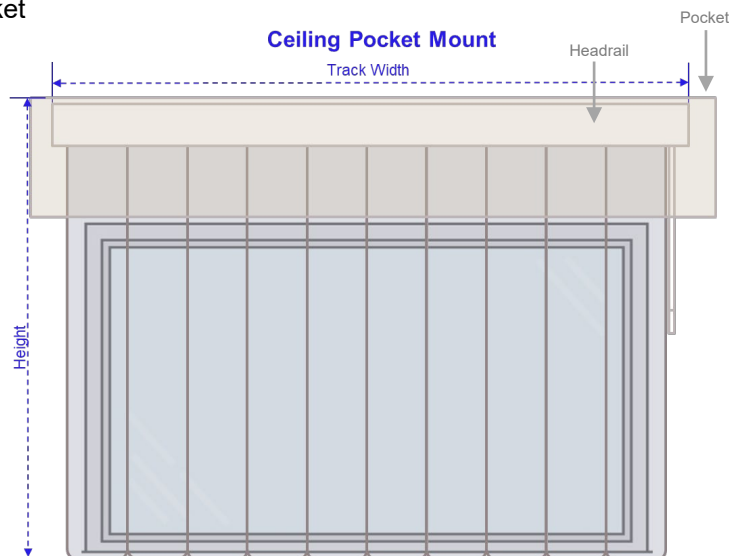
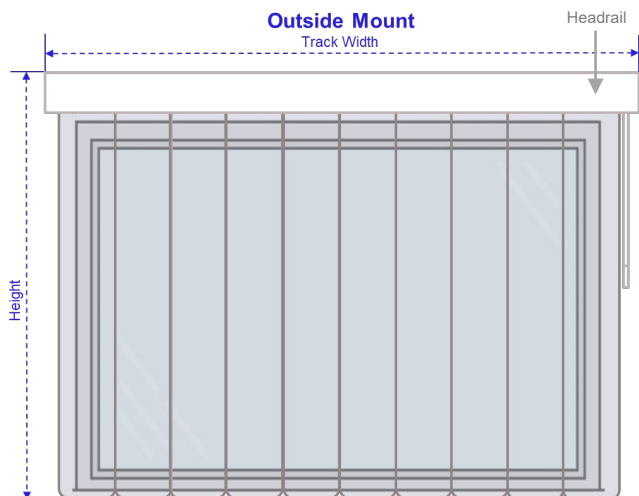

Single, Outside Mount

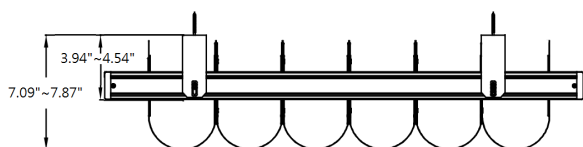

Side by Side, Outside Mount

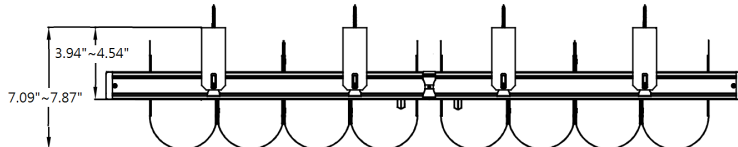

Single, Ceiling Pocket Mount

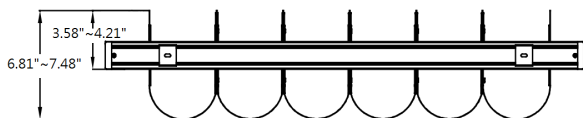

Side by Side, Ceiling Pocket Mount

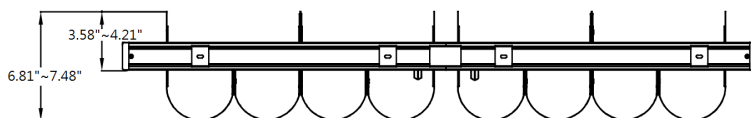

Outside Mount/Wall Mount (Windows & Patio Doors)

Order width = Track width (R)

Measured from headrail left end cap to right end cap

No Deductions

Recommendation: To minimize light leakage, fabric vanes should overlap the window opening by at least 4" on both the right & left side. Your overall width should include the amount of overlap you prefer.

Tolerance: Width = $\pm 3/4"$; Height = $\pm 1/2"$

Order height = Product height

Measured from top of headrail to bottom of fabric vane

No Deductions

Recommended for Patio Doors: fabric vanes should overlap the window opening by at least 3" at the top, and deduct 1/2" at the bottom. Consider this when entering your order.

Recommended for Windows: fabric should overlap the window opening at least 3" at the top & the bottom. Consider this when entering your order.

SmartDrape Width Definitions:

- Track Width (R): Measurement from the headrail left end cap to right end cap
- Shade Width (F) : Measurement from the first vane to the last vane when the vanes are in the open position

Mount Types and Standard Deductions

Ceiling Pocket Mount

Order width = Track width (R)

Measured from headrail left end cap to right end cap

No Deductions

Tolerance: Width = $\pm 3/4"$; Height = $\pm 1/2"$

Order height = Product Height

No Deduction

Measured from top of the inner ceiling pocket to the end of the fabric vane

Recommendation: Fabric vanes should overlap at the bottom by 3" for windows and deducted by $1/2"$ on patio doors. Consider this when entering your order.

➤ Ceiling Pocket height & (inner) depth dimensions are required for order entry.

- Min pocket depth: $4\ 7/8"$
- Max pocket depth: *no max*
- Min pocket height: *no min*
- Max pocket height: $4\ 5/8"$

➤ Hang Strips:

- When the pocket depth is over $4\ 3/4"$ but under $8\ 1/4"$ and the pocket height is over $1\ 3/4"$, a hang strip of the appropriate size will be provided based on pocket dimensions to mount the shade.
- *Finished product height = order height – hang strip size provided*

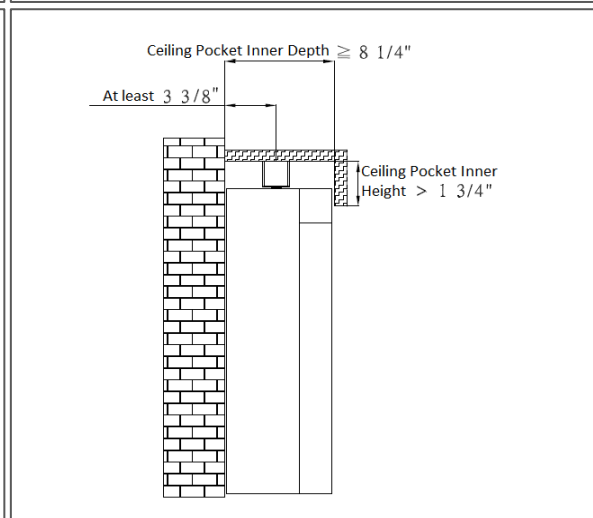
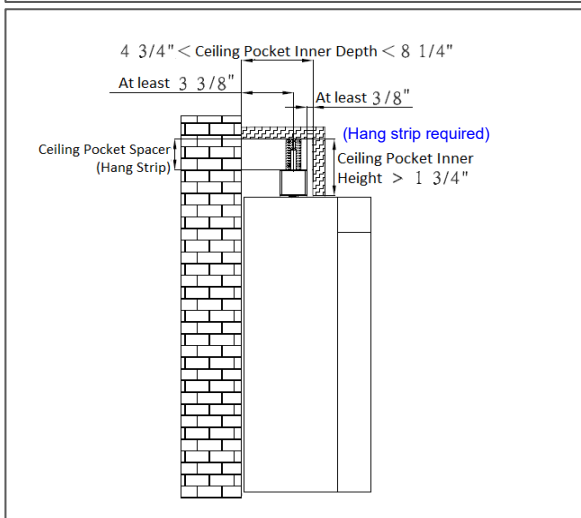
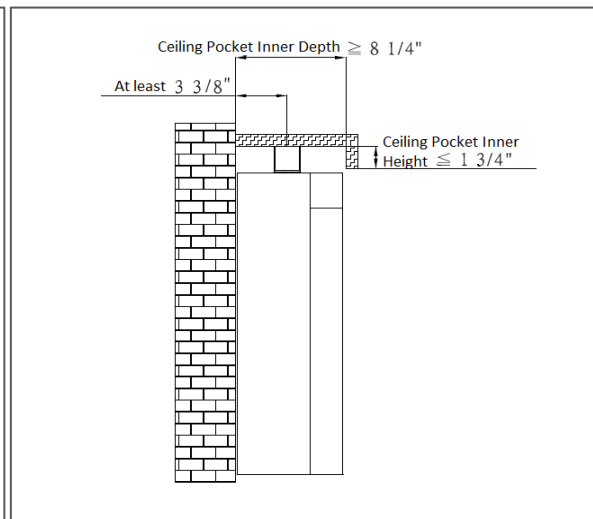
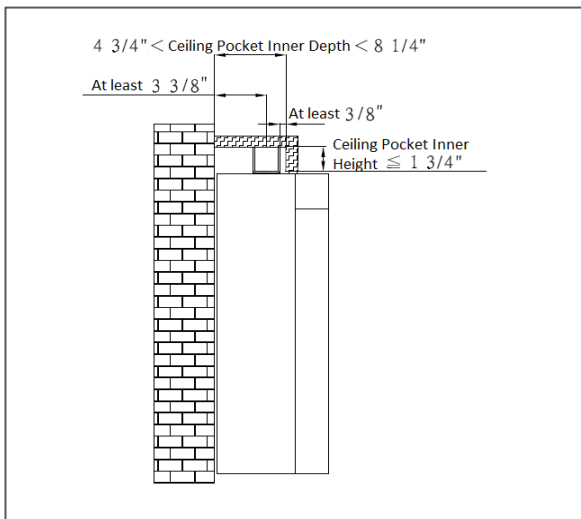
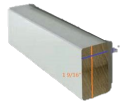
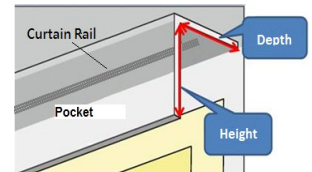

Item	Drawing		
L Brackets	<div><div><p>Standard L Bracket -Aluminum Shims add-on option available</p></div><div><p>Long L Bracket (Optional) -Not available with Aluminum Shims</p></div></div> <p>L brackets are included for Wall Mount only. Not available for Ceiling Pocket Mount.</p> <p>**0.59" actual adjustable distance for installation</p>		
Aluminum Shim (Optional)	<p>One shim per L bracket will be provided.</p>	Headrail	
C Clip	<p>-Wall Mount/OM: Comes attached onto the L bracket -Ceiling Pocket Mount: mounts directly onto ceiling (or hang strip) -Additional C Clips are provided for joining Side by Side headrails</p>		
SmartJoint™ & Optional Keystone	<p>Splices track at evenly, allowing for larger track widths for both Single and Side By Side applications. C clips are still used to combine 2 Side by Side tracks together.</p> <p>A keystone is optional for SmartJoint™ tracks and Side by Side. Not available on non-spliced tracks.</p> <div><p>Keystone</p><p>SmartJoint™ Top Connector</p><p>SmartJoint™ Bottom Connectors</p></div>		
Fabric Vane		<p>*Approx. 7" in depth. All fabric vanes are cut down to the same size. The soft nature of the fabric is the variable.</p>	

Additional Options

SmartJoint™ & Keystones

Includes connector pieces to combine a spliced headrail. This allows for larger track width options on a Single Shade and for each Side by Side Shade.

- A SmartDrape™ shade is operable under a spliced headrail and has no gaps, unlike the C clip joiner that is still required to combine 2 side by side shades together. There will be a gap in between 2 side by side shades depending on the headrail size. (See [shade configurations](#).)
- Added keystones are optional on SmartJoint™ tracks
- Optional keystone are also available for the center of Side by Side shades.
- Track Widths will be spliced once at the center with SmartJoint™ for select track sizes, and spliced twice for larger track sizes.



Keystone for SmartJoint™ and Side by Side

Aluminum Shims (for Standard L Bracket)

- Ideal for projecting the SmartDrape shade further out to provide adequate clearance when mounted above a trim or molding. (Adds 9/16" thickness)
- Available for outside mount only; not available for ceiling pocket mount
- Shims are color coordinated with the hardware
- Upgrade applies per shim. One shim will be provided for each L bracket. See table below.

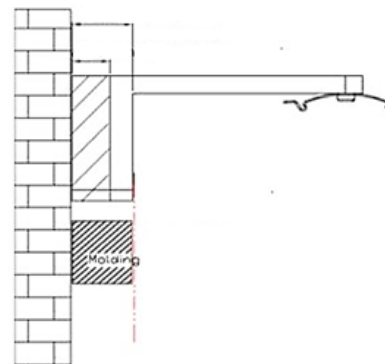

Long L Bracket

- Ideal when additional clearance is required for SmartDrape shades; no shims required.
- Extends further than Standard L bracket with 9/16" aluminum shims. Long L brackets not available to extend with Aluminum shims
- Upgrade applies per shade

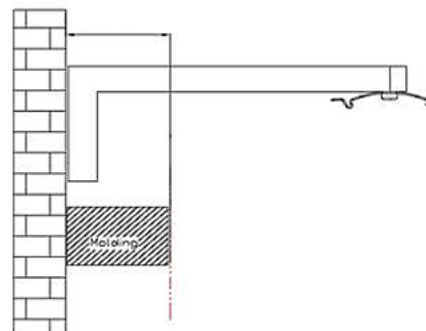

Molding	Recommended Installation
Molding $\leq 3/8"$	Standard L Bracket
$3/8" < \text{Molding} \leq 15/16"$	Standard L Bracket with Aluminum Shims (1 set)
$15/16" < \text{Molding} \leq 1 3/4"$	Long L Bracket

Hardware Quantity

SmartJoint™ Qty	Single Shade		Side by Side Shades	
	Track Width	Aluminum Shim / L Bracket Qty	Track Width	Aluminum Shim / L Bracket Qty
No SmartJoint	17 5/8" ~ 77 5/8"	2	15 5/8" ~ 79 7/8"	2
	81 5/8" ~ 93 5/8"	3	83 7/8" ~ 91 7/8"	3
1 per headrail	97 5/8" ~ 157 5/8"	4	95 7/8" ~ 156 1/8"	4
	161 5/8" ~ 189 5/8"	6	160 1/8" ~ 188 1/8"	6
2 per headrail	193 5/8" ~ 197 5/8"	6	192 1/8" ~ 196 1/8"	6
	201 5/8" ~ 285 5/8"	9	200 1/8" ~ 284 3/8"	9

Control (Wands)

- Number of Wands:** SmartDrape™ comes standard with one tilt/draw wand located on the opposite side of the stack location. An additional wand is provided on all Traveling Center Stack shades (per shade) on the opposing side, allowing the shade to be drawn or tilted from either end. Available for Single and Side by Side applications.

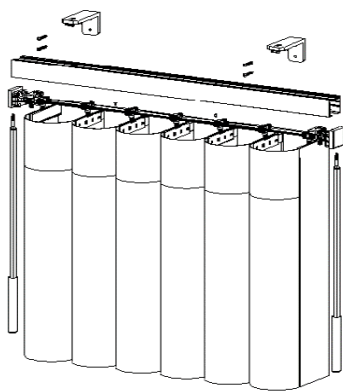

Traveling Center Stack
(Single)

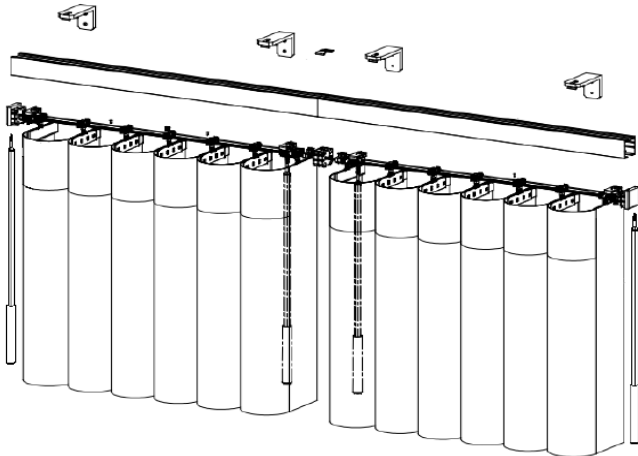

Traveling Center Stack
(Side by Side)

- Optional Wand Colors:** Wands can be selected in a different color from the headrail and other hardware components, from any of the **4 available hardware colors**. Applies to all wands if Traveling Center Stack is selected.
- Wand Drop:** The wand drop is the wand length measurement which starts at the top of the headrail to the end of the wand. Available in standard or custom sizes.
 - Standard drop: The 4 standard wand drop sizes are based on the shade height chart below.
 - Custom drop: Custom wand drops are available from 8" to 90"

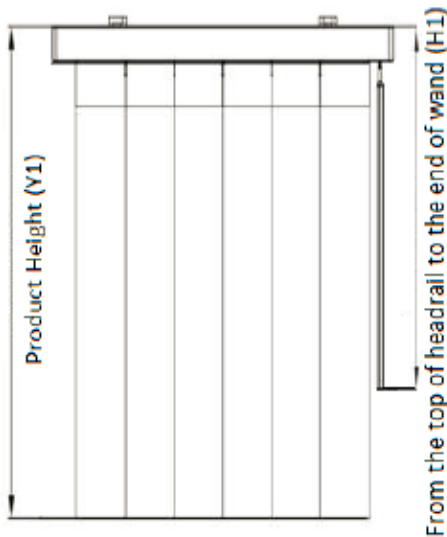

Shade Height	Standard Wand Drop
$Y1 < 36"$	24"
$36" \leq Y1 < 70"$	36"
$70" \leq Y1 < 90"$	40"
$90" \leq Y1 < 105"$	45"
$105" \leq Y1 < 110"$	55"
$110" \leq Y1 \leq 120"$	65"

Alternating Colors

Select two fabric colors to alternate the vanes of your SmartDrape™. The two colors selected will alternate, starting from left to right.

- Available for Single & Side By Side shades
- Both color selections must be in the same fabric category: RD, LF, and LF Essentials.
Example: RD + RD or Essentials + Essentials
- There is no default color coordination. The wand, headrail and hardware component colors must be specified in order entry.

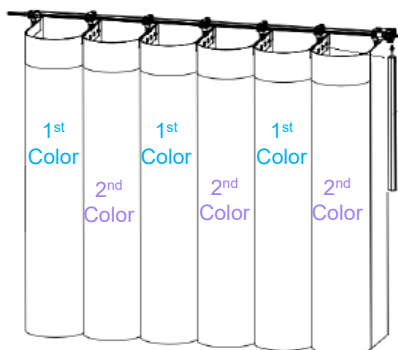

Shades with an **even** vane quantity will start and end with a vane in each color.

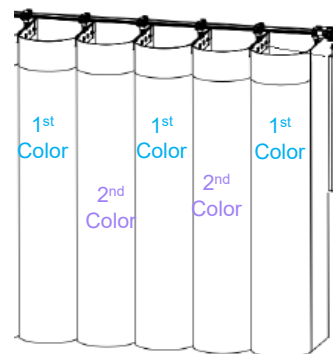

Shades with an **odd** vane quantity will start and end with the 1st color selection.

Refer to the [Shade Configuration](#) charts to determine the vane count. The desired vane count may be achieved by increasing or decreasing the ordered track width.

Additional Vanes

Extra fabric vane packs can be requested.

- Each pack consists of six vanes including one first vane, four middle vanes, and one last vane
- Additional Vane packs for Alternating Colors:
 - Left/Right stack includes one first vane, four middle vanes (two in each color), and one last vane.
 - Side by Side shades includes two first vanes, two middle vanes (one in each color), and two last vanes.
- Available as an option on the current order, or as a separate, new order*.
 - For new orders without a shade, the original WO# is required to ensure the correct order details are provided.
 - *Packs ordered without a shade will have pricing that differs from packs selected as an option with a shade order.
 - Pattern availability and color lot match cannot be assured for vane packs purchased after the original order.

Fabric List & Color Coordination

Opacity / Fabric Type	Fabric Pattern	Fabric Code	Color Code	Color Name	Hardware: Headrail / Wand / Brackets / End Caps	
Light Filtering	Plain	AG0111	F1124	Plain White	3058 White	Smooth
			F1128	Plain Ivory	3094 Cottage White	Smooth
			F1132	Plain Light Gray	4157 Matte Silver	Brushed
			F1136	Plain Gray	H201 Black	Brushed
			F1140	Plain Charcoal	H201 Black	Brushed
		AG0115	F1341	Plain Cottonwood	3094 Cottage White	Smooth
			F1345	Plain Platinum	3094 Cottage White	Smooth
	Net	AG0111	F1125	Net White	3058 White	Smooth
			F1129	Net Ivory	3094 Cottage White	Smooth
			F1133	Net Light Gray	4157 Matte Silver	Brushed
			F1137	Net Gray	H201 Black	Brushed
			F1141	Net Charcoal	H201 Black	Brushed
		AG0115	F1342	Net Cottonwood	3094 Cottage White	Smooth
			F1346	Net Platinum	3094 Cottage White	Smooth
	Pacific	AG0111	F1126	Pacific White	3058 White	Smooth
			F1130	Pacific Ivory	3094 Cottage White	Smooth
			F1134	Pacific Light Gray	4157 Matte Silver	Brushed
			F1138	Pacific Gray	H201 Black	Brushed
			F1142	Pacific Charcoal	H201 Black	Brushed
		AG0115	F1343	Pacific Cottonwood	3094 Cottage White	Smooth
			F1347	Pacific Platinum	3094 Cottage White	Smooth
	Circle	AG0111	F1127	Circle White	3058 White	Smooth
			F1131	Circle Ivory	3094 Cottage White	Smooth
			F1135	Circle Light Gray	4157 Matte Silver	Brushed
			F1139	Circle Gray	H201 Black	Brushed
			F1143	Circle Charcoal	H201 Black	Brushed
		AG0115	F1344	Circle Cottonwood	3094 Cottage White	Smooth
			F1348	Circle Platinum	3094 Cottage White	Smooth
	Coronado	AG0111	F1585	Coronado White	3058 White	Smooth
			F1586	Coronado Ivory	3094 Cottage White	Smooth
			F1587	Coronado Light Gray	4157 Matte Silver	Brushed
			F1588	Coronado Gray	H201 Black	Brushed
			F1589	Coronado Charcoal	H201 Black	Brushed
			F1590	Coronado Cottonwood	3094 Cottage White	Smooth
	Teardrop	AG0111	F1592	Teardrop White	3058 White	Smooth
			F1593	Teardrop Ivory	3094 Cottage White	Smooth
			F1594	Teardrop Light Gray	4157 Matte Silver	Brushed
			F1595	Teardrop Gray	H201 Black	Brushed
			F1596	Teardrop Charcoal	H201 Black	Brushed
			F1597	Teardrop Cottonwood	3094 Cottage White	Smooth
Light Filtering: Essentials	Lakeshore Stripe	AG0123	F1663	Lakeshore Stripe White	3058 White	Smooth
			F1664	Lakeshore Stripe Light Gray	4157 Matte Silver	Brushed
			F1665	Lakeshore Stripe Charcoal	H201 Black	Brushed
Room Darkening		AG0116	F1169	Soft White	3058 White	Smooth
			F1170	Crema	3094 Cottage White	Smooth
			F1171	Coffee	H201 Black	Brushed
			F1172	Carbon	H201 Black	Brushed
		AG0112	F1603	Light Gray	4157 Matte Silver	Brushed
			F1604	Cottonwood	3094 Cottage White	Smooth

Fabric Composition: 100% Polyester



Color Coordination Override:

Each fabric will have coordinated default hardware colors. To override the default colors, please select from any of the 4 colors during order entry. Wands are available for a color override selection, separate from the headrail and other components.

Color Availability				
	White	Cottage White	Matte Silver	Black
Headrail / Keystone (Color Coordination override available)	✓	✓	✓	✓
Wand (Defaults to headrail selection; Color Coordination override available)	✓	✓	✓	✓
Standard L Bracket (Matches headrail selection)	✓	✓	✓	✓
Long L Bracket (Matches headrail selection)	✓	✓	✓	✓
Optional Shims (Matches headrail selection)	✓	✓	✓	✓

*Light Bronze hardware color discontinued on 1/1/2024.

All fabrics will adjust to the environment and its environmental changes. These fabric adjustments may include color fading, fabric stretching, fabric shrinkage, or other damages.

Color Variation

- Colors may appear to vary depending on the time of day and lighting type under which the product is observed.
- All fabric colors gradually fade due to UV exposure. Fabrics will fade more evenly if fabrics are closed during the day. Naturally, parts of the fabric that are overlapped by another piece of fabric will not receive as much solar exposure, and thus the rate in which it fades will be slower than those parts that are more exposed.
- For the best color match, order all matching shades for a room at the same time. Pattern availability and color lot match between orders cannot be assured. Any variation in color is in accordance with industry standards.

Wrinkles

For SmartDrape™, wrinkles may occur after washing or long transportation. If your shade is wrinkled, hang it for a few days. This will help minimize the wrinkles, allowing them to usually disappear naturally. Or you may choose to steam or iron the fabric panels.

Vane Structure

Due to the natural, free-flowing characteristics of sheer fabric, the bottom of the fabric vanes may not form a perfect U shape. Taller height drapery with sheer fabrics can flare at the bottom and may not be as tight as the top of the drape. RGAs will not be accepted for this reason.

Room Darkening: RD fabrics in particular, are stiffer than LF fabrics due to their natural structure. If the bottom of the fabric vane is slightly curved when the shade is received, you can correct this issue by rolling the vane in the opposite direction and using a fabric steamer to soften the bend.



Operating SmartDrape™

Be sure the fabric vanes are in an open position when stacking the shade open or closed.

Product Care

Washing Instructions

1. Remove the fabric from the fabric vane clip.
2. Fold the fabrics and place them in a mesh laundry bag.
3. Wash with cold water; gentle cycle. **Note: Do not use bleach or cleaning products that contain bleach.
4. Do not add extra spin after wash. Remove the fabric.
5. Hang the fabrics to line dry, until the fabrics are slightly damp. Fan drying is acceptable.
6. Re-assemble all slats on the rail and leave the vanes open until completely dried. This will also help avoid wrinkles.

Ironing or steaming:

Use a steam iron to smooth out any wrinkles that may develop.

